

**NOTICE!!**

**These documents have been scanned!**

**Do not place un-scanned documents beneath this notice!**

**Do not remove this notice from this file!**

GPO Jacket No. 560-102  
Print Order 61540  
Rise Business Services, LLC  
Job=AZ15 5/13/2019



Box Number= AZ15044



Claim Begin-End: AMC417748-AMC417749

1 Initial Receipt



AZ15044-7

AMC417667-AMC418586

**United States Department of the Interior**  
**Bureau of Land Management**  
 LANDS/RECREATION & PLANNING  
 ONE N CENTRAL AVE  
 PHOENIX, AZ 85004 -2203  
 Phone: 602-417-9200

Receipt

No: 2668338

Transaction #: 2749458	ENTERED INTO COMPUTER
Date of Transaction: 10/09/2012	
CUSTOMER: OCT 18 2012 <i>RB</i>	
RUSSELL WILLIAMS 9064 E GARY LN MESA, AZ 85207-4236 US	

LINE #	QTY	DESCRIPTION	REMARKS	UNIT PRICE	TOTAL
1	2.00	LOCATABLE MINERALS / MINING CLAIMS- NEW, UNADJUD, ONE OR MORE AUTH NOS / NEW MINING CLAIM LOCATION FEE \$34 <b>CASES:</b> AMC417748/\$34.00, AMC417749/\$34.00		- n/a -	68.00
2	2.00	LOCATABLE MINERALS / MINING CLAIMS- NEW, UNADJUD, ONE OR MORE AUTH NOS / NEW MINING CLAIM MAINT FEE \$140 <b>CASES:</b> AMC417748/\$140.00, AMC417749/\$140.00		- n/a -	280.00
3	2.00	LOCATABLE MINERALS / MINING CLAIMS- NEW, UNADJUD, ONE OR MORE AUTH NOS / NEW MINING CLAIM PROCESSING FEE \$15 <b>CASES:</b> AMC417748/\$15.00, AMC417749/\$15.00		- n/a -	30.00
<b>TOTAL:</b>					<b>\$378.00</b>

PAYMENT INFORMATION			
NOTE: Items will appear on credit card statement as "Bureau of Land Mgmt CO".			
1	AMOUNT:	378.00	POSTMARKED: N/A
	TYPE:	CREDIT CARD	RECEIVED: 10/09/2012
	NAME:	WILLIAMS, RUSSELL 9064 E GARY LN MESA AZ 85207-4236 US	
	CARD NO:	XXXXXXXXXXXX4225	AUTH CODE: 03973G
	NAME ON CARD:	WILLIAMS RUSSELLF	
	EXPIRES:	08/2013	
	SIGNATURE:		

REMARKS



**NOTICE!!**

**These documents have been scanned!**

**Do not place un-scanned documents beneath this notice!**

**Do not remove this notice from this file!**

GPO Jacket No. 560-102  
Print Order 61540  
Rise Business Services, LLC  
Job=AZ15 5/13/2019



Box Number= AZ15044



Claim Begin-End: AMC417748-AMC417749

2 Correspondence



AZ15044-7

AMC417667-AMC418586



# United States Department of the Interior



BUREAU OF LAND MANAGEMENT

Arizona State Office

One North Central Avenue, Suite 800

Phoenix, Arizona 85004-4427

[www.blm.gov/az/](http://www.blm.gov/az/)

DEC 18 2018

In Reply Refer To:  
3830 (9200) PB  
AMC417748

CERTIFIED MAIL - RETURN RECEIPT REQUESTED No. 9214 8901 9403 8376 3566 04

## DECISION

SCOTT WILLIAMS  
7916 E IRWIN AVE  
MESA, AZ 85209-4256

:  
:  
:

This decision affects those claims shown in the block below.

---

AMC417749  
NO CLUE #2

---

## MINING CLAIMS DECLARED FORFEITED

The mining claims listed above have been declared forfeited as of September 1, 2018, for failure to timely file the required maintenance fee payment or small miner's maintenance fee waiver (waiver).

Claimants are required to pay an annual non-refundable maintenance fee of \$155 per 20 acres or portion thereof, or submit a waiver, on or before September 1 of each year. These requirements were established by 30 U.S.C. 28f-1, as amended, and 43 CFR 3834 and 3835.

Our records do not show receipt of a maintenance fee payment or small miner waiver filed on or before the due date. Therefore, the claims listed above are forfeited.

## Reclamation Requirements

This decision does not relieve you of the liability for reclamation of all areas disturbed by your activities on lands covered by the subject mining claim(s) and/or site(s). After you complete the reclamation, you must notify the authorized officer of the appropriate surface managing agency so that the authorized officer may conduct a final site inspection and determine whether you may be released from liability. If you fail to reclaim the land to the satisfaction of the authorized



officer, the surface management agency may cite you for noncompliance under its surface management regulations. For land administered by the Bureau of Land Management (BLM), if you fail to reclaim the land to the satisfaction of the authorized officer as required in 43 CFR Subpart 3809, the BLM will issue an order of noncompliance under 43 CFR 3809.601(a). If you fail to comply with the non-compliance order, BLM may take further action under 43 CFR 3809.604. Failure to conduct reclamation is a prohibited act that may subject you to criminal penalties. See 43 CFR 3809.605(h) and 43 CFR 3809.700.

### Appeal Procedures

This decision may be appealed to the Interior Board of Land Appeals, Office of the Secretary, in accordance with the regulations contained in 43 CFR, Part 4, and the enclosed Form 1842-1. If an appeal is taken, your notice of appeal must be filed in this office (at the above address) within 30 days from receipt of this decision. The appellant has the burden of showing that the decision appealed from is in error.

If you wish to file a petition pursuant to regulation 43 CFR 4.21 (58 FR 4939, January 19, 1993) for a stay of the effectiveness of this decision during the time that your appeal is being reviewed by the Board, the petition for a stay must accompany your notice of appeal. A petition for a stay is required to show sufficient justification based on the standards listed below. Copies of the notice of appeal and petition for a stay **must** also be submitted to each party named in this decision and to the Interior Board of Land Appeals and to the appropriate Office of the Solicitor (see 43 CFR 4.413) at the same time the original documents are filed with this office. If you request a stay, you have the burden of proof to demonstrate that a stay should be granted.

### Standards for Obtaining a Stay

Except as otherwise provided by law or other pertinent regulation, a petition for a stay of a decision pending appeal shall show sufficient justification based on the following standards:

- (1) The relative harm to the parties if the stay is granted or denied,
- (2) The likelihood of the appellant's success on the merits,
- (3) The likelihood of immediate and irreparable harm if the stay is not granted, and
- (4) Whether the public interest favors granting the stay.

Please include your AMC serial number(s) on all correspondence. If additional information is required, please call Pauline Brown at 602-417-9360.

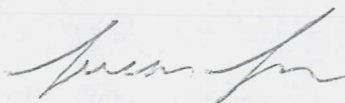

Lucas Lucero  
Deputy State Director  
Lands, Minerals, and Energy Division

Enclosure

**CERTIFIED MAIL™**



nepost  
20/2018  
**POSTAGE**

**PHOENIX, ARIZONA**

**2019 JAN 28 A 10:04**

**\$05.63<sup>00</sup>**  
OFFICIAL MAIL  
\$300 Penalty  
for Private Use  
ZIP 85004  
044811101433

**RECEIVED**  
STATE OFFICE

NIXIE 858 05 1 0001/09/19  
RETURN TO SENDER  
REFUSED  
UNABLE TO FORWARD  
BC: 85004442700 \*0614-09178-20-43

REF  
44427



AZ9200/PB/AMC417748





DATE PRODUCED: 1/14/2019 6:01 PM

US DEPARTMENT OF THE INTERIOR BUREAU OF LAND MANAGEMENT:

The following is information for Certified Mail™/RRE item number:

9214 8901 9403 8376 3566 04

Our records indicate that this item was RETURNED TO SENDER.

ORIGINAL INTENDED RECIPIENT:

SCOTT WILLIAMS

7916 E IRWIN AVE

MESA AZ 85209-4256

The above information represents information provided by the United States Postal Service.

Return Reference Number:



**NOTICE!!**

**These documents have been scanned!**

**Do not place un-scanned documents beneath this notice!**

**Do not remove this notice from this file!**

GPO Jacket No. 560-102  
Print Order 61540  
Rise Business Services, LLC  
Job=AZ15 5/13/2019



Box Number= AZ15044



Claim Begin-End: AMC417748-AMC417749

3 Transfers



AZ15044-7

AMC417667-AMC418586

**NO  
DOCUMENTS  
FOUND**

NO DOCUMENTS FOUND  
NO DOCUMENTS FOUND

**NOTICE!!**

**These documents have been scanned!**

**Do not place un-scanned documents beneath this notice!**

**Do not remove this notice from this file!**

GPO Jacket No. 560-102  
Print Order 61540  
Rise Business Services, LLC  
Job=AZ15 5/13/2019



Box Number= AZ15044



Claim Begin-End: AMC417748-AMC417749

4 Miscellaneous



AZ15044-7

AMC417667-AMC418586



**NO  
DOCUMENTS  
FOUND**

NO DOCUMENTS FOUND  
NO DOCUMENTS FOUND

**NOTICE!!**

**These documents have been scanned!**

**Do not place un-scanned documents beneath this notice!**

**Do not remove this notice from this file!**

GPO Jacket No. 560-102  
Print Order 61540  
Rise Business Services, LLC  
Job=AZ15 5/13/2019



Box Number= AZ15044



Claim Begin-End: AMC417748-AMC417749

5 Annual Filings



AZ15044-7

AMC417667-AMC418586

UNITED STATES  
DEPARTMENT OF THE INTERIOR  
BUREAU OF LAND MANAGEMENT

398

PER

430614  
417748

MAINTENANCE FEE WAIVER CERTIFICATION

FORM APPROVED  
OMB NO. 1004-0114  
Expires: January 31, 2020

SEE INSTRUCTIONS ON PAGE 2

1. This small miner waiver is filed for the assessment year beginning on September 1, 2019 and ending on September 1, 2020
2. The undersigned and all related parties owned ten or fewer mining claims, mill, or tunnel sites located and maintained on Federal lands in the United States of America on September 1, 2019.
3. The undersigned have performed the assessment work required by law for each mining claim listed prior to filing this waiver and understand that by filing this form, the undersigned must file an affidavit of assessment work with the Bureau of Land Management (BLM) by the December 30th following the filing of this waiver.
4. The undersigned understand that if the assessment work obligation has not yet come due under 30 U.S.C. 28 (for those claims in their first assessment year only), a notice of intent to hold reciting this condition must be recorded by the December 30th following the filing of this waiver.
5. The undersigned understand that mill and tunnel sites may also be listed on this waiver and be waived from payment of the maintenance fee, and that a notice of intent to hold for these sites is required to be filed with the BLM by the December 30th following the filing of this waiver.
6. The undersigned understand and acknowledge that pursuant to 43 U.S.C. 1212 and 18 U.S.C. 1001, the filing or recording of a false, fictitious, or fraudulent document with the BLM may result in a fine of up to \$250,000, a prison term not to exceed five years, or both.
7. The mining claims, mill or tunnel sites for which this waiver from payment of the maintenance fees is requested are:

CLAIM OR SITE NAME	BLM RECORDATION SERIAL NUMBER
1. Two Brothers Gulch ✓	AMC 430614
2. NO Clue #1	AMC 417748
3.	
4.	
5.	
6.	
7.	
8.	
9.	
10.	

RECEIVED  
BLM STATE OFFICE  
2019 AUG 29 A 11:02  
PHOENIX, ARIZONA

The owner(s) (claimants) of the above mining claims and sites are:

Russell Williams  
(Owner's Name - Please Print)

9064 e. gary LN.  
(Owner's Mailing Address)

Russell Williams  
(Owner's Signature)

Mesa AZ 85207  
(City) (State) (Zip Code)

Russell Williams  
(Owner's Name - Please Print)

9064 e. gary LN.  
(Owner's Mailing Address)

Russell Williams  
(Owner's Signature)

Mesa AZ 85207  
(City) (State) (Zip Code)

(Owner's Name - Please Print)

(Owner's Mailing Address)

(Owner's Signature)

(City)

(State)

(Zip Code)

(Owner's Name - Please Print)

(Owner's Mailing Address)

(Owner's Signature)

(City)

(State)

(Zip Code)

ENTERED  
SEP 18 2019

BY: *[Signature]*

*[Handwritten initials]*



\_\_\_\_\_  
(Owner's Name - Please Print)

\_\_\_\_\_  
(Owner's Signature)

\_\_\_\_\_  
(Owner's Mailing Address)

\_\_\_\_\_  
(City) (State) (Zip Code)

\_\_\_\_\_  
(Owner's Name - Please Print)

\_\_\_\_\_  
(Owner's Signature)

\_\_\_\_\_  
(Owner's Mailing Address)

\_\_\_\_\_  
(City) (State) (Zip Code)

\_\_\_\_\_  
(Owner's Name - Please Print)

\_\_\_\_\_  
(Owner's Signature)

\_\_\_\_\_  
(Owner's Mailing Address)

\_\_\_\_\_  
(City) (State) (Zip Code)

\_\_\_\_\_  
(Owner's Name - Please Print)

\_\_\_\_\_  
(Owner's Signature)

\_\_\_\_\_  
(Owner's Mailing Address)

\_\_\_\_\_  
(City) (State) (Zip Code)

18 U.S.C. 1001 and 43 U.S.C. 1212 make it a crime for any person knowingly and willfully to make to any department or agency of the United States any false, fictitious or fraudulent statements or representations as to any matter within its jurisdiction.

INSTRUCTIONS

1. This certification is made under the provisions of 43 U.S.C. § 1744 and 30 U.S.C. §28-28k and the regulations thereunder (43 CFR Part 3830).
2. The claimant(s) must fill in the dates in paragraph 1 for the beginning and ending of the assessment year for which this waiver is sought.
3. The claimant(s) must fill in the date in paragraph 2 for the beginning of the assessment year for which this waiver is sought.
4. All claim and site names and BLM serial numbers must be listed for the mining claims, mill sites, and tunnel sites for which the waiver is sought.
5. All owners of the mining claims, mill sites, and tunnel sites and their addresses must be given.
6. This waiver form must be signed by all the claimants or their designated agent, in original form. If an agent is designated, a notarized designation of agent, signed by all of the claimants with proper address given, must be submitted with this waiver.
7. This form must be filed no later than September 1st for the upcoming assessment year in the BLM State Office where the mining claims or sites are recorded, or the waiver cannot be granted by the BLM. (Example: To obtain a waiver for the assessment year 2012, which begins on September 1, 2011, you must qualify for and file for a waiver no later than September 1, 2011, in the proper BLM State Office.)
8. For all mining claims which require assessment work, you must record an affidavit of labor on or before the December 30th immediately following the filing of this waiver. For all other mining claims or sites waived, you must record a notice of intent to hold on or before the December 30th immediately following the filing of this waiver.
9. Mill and tunnel sites may also be listed on this waiver and be waived from payment of the maintenance fee. A notice of intent to hold for these sites is required to be filed by the December 30th following the filing of this waiver.

RECEIVED  
 STATE OFFICE  
 PHOENIX ARIZONA  
 2011 AUG 9 4:11:02 PM

FOR OFFICIAL USE ONLY

UNITED STATES  
DEPARTMENT OF THE INTERIOR  
BUREAU OF LAND MANAGEMENT  
MAINTENANCE FEE WAIVER CERTIFICATION

SEE INSTRUCTIONS ON PAGE 2

PER

430614  
417748

FORM APPROVED  
OMB NO. 1004-0114  
Expires: January 31, 2020

- This small miner waiver is filed for the assessment year beginning on September 1, 2018 and ending on September 1, 2019
- The undersigned and all related parties owned ten or fewer mining claims, mill, or tunnel sites located and maintained on Federal lands in the United States of America on September 1, 2018
- The undersigned have performed the assessment work required by law for each mining claim listed prior to filing this waiver and understand that by filing this form, the undersigned must file an affidavit of assessment work with the Bureau of Land Management (BLM) by the December 30th following the filing of this waiver.
- The undersigned understand that if the assessment work obligation has not yet come due under 30 U.S.C. 28 (for those claims in their first assessment year only), a notice of intent to hold reciting this condition must be recorded by the December 30th following the filing of this waiver.
- The undersigned understand that mill and tunnel sites may also be listed on this waiver and be waived from payment of the maintenance fee, and that a notice of intent to hold for these sites is required to be filed with the BLM by the December 30th following the filing of this waiver.
- The undersigned understand and acknowledge that pursuant to 43 U.S.C. 1212 and 18 U.S.C. 1001, the filing or recording of a false, fictitious, or fraudulent document with the BLM may result in a fine of up to \$250,000, a prison term not to exceed five years, or both.
- The mining claims, mill or tunnel sites for which this waiver from payment of the maintenance fees is requested are:

CLAIM OR SITE NAME	BLM RECORDATION SERIAL NUMBER
1. Two Brothers Gulch	AMC-430614 (913)
2. NO Clue #1	AMC-417748
3.	
4.	
5.	
6.	
7.	
8.	
9.	
10.	

The owner(s) (claimants) of the above mining claims and sites are:

201 Russell Williams  
(Owner's Name - Please Print)  
9064 e. gary LN. ✓  
(Owner's Mailing Address)

Russell Williams  
(Owner's Signature)  
Mesa AZ 85207  
(City) (State) (Zip Code)

Russell Williams  
(Owner's Name - Please Print)  
9064 e. gary LN.  
(Owner's Mailing Address)

Russell Williams  
(Owner's Signature)  
Mesa AZ 85207  
(City) (State) (Zip Code)

(Owner's Name - Please Print)

(Owner's Mailing Address)

(Owner's Name - Please Print)

(Owner's Mailing Address)

(Owner's Signature)

(City)

(Owner's Signature)

(City)

(State)

(State)

(Zip Code)

(Zip Code)

AC 483  
ENTERED SEP 12 2018  
PB

PHOENIX, ARIZONA  
2018 AUG 20 A 9:34  
RECEIVED  
BLM AZ STATE OFFICE

(Continued on page 2)

NW  
RB

(Owner's Name - Please Print)

(Owner's Signature)

(Owner's Mailing Address)

(City)

(State)

(Zip Code)

(Owner's Name - Please Print)

(Owner's Signature)

(Owner's Mailing Address)

(City)

(State)

(Zip Code)

(Owner's Name - Please Print)

(Owner's Signature)

(Owner's Mailing Address)

(City)

(State)

(Zip Code)

(Owner's Name - Please Print)

(Owner's Signature)

(Owner's Mailing Address)

(City)

(State)

(Zip Code)

18 U.S.C. 1001 and 43 U.S.C. 1212 make it a crime for any person knowingly and willfully to make to any department or agency of the United States any false, fictitious or fraudulent statements or representations as to any matter within its jurisdiction.

INSTRUCTIONS

1. This certification is made under the provisions of 43 U.S.C. § 1744 and 30 U.S.C. §28-28k and the regulations thereunder (43 CFR Part 3830).
2. The claimant(s) must fill in the dates in paragraph 1 for the beginning and ending of the assessment year for which this waiver is sought.
3. The claimant(s) must fill in the date in paragraph 2 for the beginning of the assessment year for which this waiver is sought.
4. All claim and site names and BLM serial numbers must be listed for the mining claims, mill sites, and tunnel sites for which the waiver is sought.
5. All owners of the mining claims, mill sites, and tunnel sites and their addresses must be given.
6. This waiver form must be signed by all the claimants or their designated agent, in original form. If an agent is designated, a notarized designation of agent, signed by all of the claimants with proper address given, must be submitted with this waiver.
7. This form must be filed no later than September 1st for the upcoming assessment year in the BLM State Office where the mining claims or sites are recorded, or the waiver cannot be granted by the BLM. (Example: To obtain a waiver for the assessment year 2012, which begins on September 1, 2011, you must qualify for and file for a waiver no later than September 1, 2011, in the proper BLM State Office.)
8. For all mining claims which require assessment work, you must record an affidavit of labor on or before the December 30th immediately following the filing of this waiver. For all other mining claims or sites waived, you must record a notice of intent to hold on or before the December 30th immediately following the filing of this waiver.
9. Mill and tunnel sites may also be listed on this waiver and be waived from payment of the maintenance fee. A notice of intent to hold for these sites is required to be filed by the December 30th following the filing of this waiver.

RECEIVED  
MAY 14 10 05 AM '11

FOR OFFICIAL USE ONLY



## NOTICES

The Privacy Act and 43 CFR 2.223(d) require that you be furnished the following information in connection with the information requested by this form.

**AUTHORITY:** 30 U.S.C. 28f and 43 CFR part 3835 permit collection of the information requested by this form.

**PRINCIPAL PURPOSE:** The BLM will use the information you provide to verify that the owner(s) (claimant(s)) of a mining claim has have complied with 30 U.S.C. 28f and 43 CFR part 3835 and is are entitled to perform assessment work in lieu of paying the maintenance fee for the mining claims listed on this form.

**ROUTINE USES:** The BLM will only disclose this information in accordance with the provisions at 43 CFR 2.231(b) and (c).

**EFFECT OF NOT PROVIDING INFORMATION:** Disclosure of the requested information is required by 30 U.S.C. 28f and 43 CFR part 3835 for those claimants qualified to request the small miner waiver allowed. Failure to submit all the requested information or to complete this form will delay the BLM's processing of the form and may preclude the BLM's acceptance of the maintenance fee waiver request, which may result in forfeiture of the mining claim or site by the claimant.

**The Paperwork Reduction Act** requires us to inform you that:

The BLM collects this information to determine whether or not you are qualified for waiver of maintenance fees.

Submission of the requested information is necessary to obtain or retain a benefit.

You do not have to respond to this or any other Federal agency-sponsored information collection unless it displays a currently valid OMB control number.

**BURDEN HOURS STATEMENT:** Public reporting burden for this form is estimated to average 20 minutes per response, including the time for reviewing instructions, gathering and maintaining data, and completing and reviewing the form. You may submit comments regarding the burden estimate or any other aspect of this form to: U.S. Department of the Interior, Bureau of Land Management (1004-0114), Bureau Information Collection Clearance Officer (WO-630), Mail Stop 401 LS, 1849 C St., N.W., Washington, D.C. 20240.

UNITED STATES  
DEPARTMENT OF THE INTERIOR  
BUREAU OF LAND MANAGEMENT

FORM APPROVED  
OMB NO.: 1004-0114  
Expires:

430614  
417748

**AFFIDAVIT OF ANNUAL ASSESSMENT WORK**

WHEN RECORDED, MAIL DOCUMENT TO:

NAME: Russell Williams

ADDRESS: 9064 e gary Ln.

CITY, STATE, ZIP: Mesa, Az 85207

FOR COUNTY RECORDER'S USE

No. of Claims \_\_\_\_\_  
x \$10/claim  
Total due BLM \$ \_\_\_\_\_

TO ALL WHOM IT MAY CONCERN:

1. The undersigned certifies that at least \$100 per claim was expended for development, labor and improvements, or equivalent value added, as the annual assessment work for the assessment year ending September 1, 2017 for the following contiguous unpatented mining claim(s), located in the County of Pinal, in the State of Arizona.

BLM Serial No.	Name of Claim	Tp	Rg	Sec	Mer	County Recordation Book and Page No.	Date
AMC-430614	Two Brothers Gulch	2S	11E	23	014		

RECEIVED  
STATE OFFICE  
2017 DEC 18 P 12:04  
PHOENIX, ARIZONA

# 4044421

ENTERED  
DEC 26 2017  
RAM

2. Type of labor and improvements (specify what was done and give the total value for that labor and improvement to show at least \$100 for each claim). If a geological, geochemical, or geophysical survey was performed, as per 30 U.S.C. 28-1, reference the title of the report of survey, give cost and date of the survey and report, and indicate it was filed with the County Recorder:

Description of Work Performed	Value of Work Performed	Date Work Was Performed
Metal detecting	\$150 <sup>00</sup>	Feb-1-2017
Cleaning up trash		
Sampling		

3. Name and mailing address of each person who performed the labor and improvements:

Name (please print)

Russell Williams

Current Mailing Address (please print)

9064 e. Gary Ln Mesa Az 85207

4. Name and mailing address of each person who holds and claims the subject mining claim(s) for the valuable minerals contained therein. Be sure to indicate if there is a change of address:

Name (please print)

Current Mailing Address (please print)

\_\_\_\_\_  
 \_\_\_\_\_  
 \_\_\_\_\_  
 \_\_\_\_\_  
 \_\_\_\_\_  
 \_\_\_\_\_  
 \_\_\_\_\_

\_\_\_\_\_  
 \_\_\_\_\_  
 \_\_\_\_\_  
 \_\_\_\_\_  
 \_\_\_\_\_  
 \_\_\_\_\_  
 \_\_\_\_\_

RECEIVED  
 STATE OFFICE  
 2017 DEC 18 PM 12:04  
 PHOENIX, ARIZONA

5. The undersigned testifies that on the date of \_\_\_\_\_, 20\_\_\_\_, all monuments required by law were erected upon the subject claim(s), and all notices required by law were posted on the subject claim(s) or copies thereof were in place, and at said date, each corner monument bore or contained



markings sufficient to appropriately designate the corner of the claim to which it pertains and the name of the claim(s).

I hereby certify under penalty of perjury under the laws of the State of Arizona that the foregoing statements are true and correct:

Russell Wilson Date: 12-18-17  
(Signature of person responsible for above statement)

Title 18 U.S.C. 1001 and 43 U.S.C. 1212 make it a crime for any person knowingly and willfully to make to any department or agency of the United States any false, fictitious or fraudulent statements or representations as to any matter within its jurisdiction.

**Notary Block**

SUBSCRIBED AND SWORN TO before me, this 19<sup>th</sup> day of December 20 17.

By: [Signature]  
(Signature of Affiant)

Title: Public Worker

My Commission Expires: 10-01-18

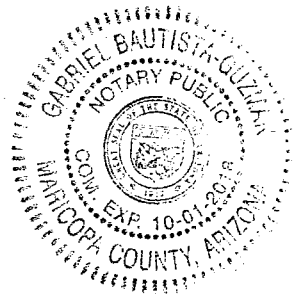

**INSTRUCTIONS**

1. This is an optional form that may be used to satisfy the requirements for the Bureau of Land Management (BLM) under the provisions of 43 U.S.C. §1744 and 30 U.S.C. §28-28d and the regulations thereunder (43 CFR part 3835). Since local and State laws may vary, you should contact your local and State agencies where the claims are located to ensure all applicable laws and requirements are satisfied.
2. The claimant(s) must fill in the date in paragraph 1 for the applicable assessment year and the county and state where the claims are located.
3. All claim names, BLM serial numbers, legal descriptions, and original county recording information must be listed for the claims pertaining to this assessment notice.
4. The claimant(s) must complete paragraph 2 listing all labor or improvements which was performed on or did benefit the subject mining claims. The value and date of the labor or improvements must also be listed. The total amount of labor or improvements can be listed, but the total expenditure must equal at least \$100 for each claim.
5. The names and current mailing addresses of the person(s) performing the labor shall be listed in paragraph 3.
6. The name and current mailing address of each owner (claimant) of the claims shall be listed in paragraph 4. The mailing address shall be the owner's address and not the address of an agent or anyone representing the claimant. Be sure to note if there has been a change of address.
7. Paragraph 5 shall be completed to show the date it was verified that all monuments required by law were properly erected, all notices were posted, and that corners were appropriately designated for all claims listed.
8. An exact legible reproduction or duplicate (other than microfilm or other electronic media) of this affidavit or another type of affidavit of assessment work that you file or will file in the county where each claim is located, must be filed with the BLM on or before December 30 of the calendar year in which the assessment year ends. For mill or tunnel sites, a separate notice of intent to hold must be filed with the BLM on or before December 30. Requirements for filing a notice of intent to hold can be found at 43 CFR 3835.33.
9. A processing fee of \$10 for each claim listed must be submitted to the BLM along with this or any other affidavit of assessment work.

RECEIVED  
MAR 27 STATE OFFICE

UNITED STATES  
DEPARTMENT OF THE INTERIOR  
BUREAU OF LAND MANAGEMENT

FORM APPROVED  
OMB NO.: 1004-0114  
Expires:

**AFFIDAVIT OF ANNUAL ASSESSMENT WORK**

WHEN RECORDED, MAIL DOCUMENT TO:

NAME: Russell Williams

ADDRESS: 9064 e. gary Ln.

CITY, STATE, ZIP: Mesa, AZ  
85207

FOR COUNTY RECORDER'S USE

No. of Claims 1

x \$10/claim

Total due BLM \$ \_\_\_\_\_

TO ALL WHOM IT MAY CONCERN:

1. The undersigned certifies that at least \$100 per claim was expended for development, labor and improvements, or equivalent value added, as the annual assessment work for the assessment year ending September 1, 2017 for the following contiguous unpatented mining claim(s), located in the County of Maricopa, in the State of Arizona.

BLM Serial No.	Name of Claim	Tp	Rg	Sec	Mer	County Recordation Book and Page No.	Date
		Example: 13N 5E 14 MDM					
AMC 417748	No clue #1	4N	9W	7	014		
AMC 417749	No clue #2	4N	9W	7	014		

RECEIVED  
STATE OFFICE  
2017 DEC 18 P 12:05  
PHOENIX, ARIZONA

2. Type of labor and improvements (specify what was done and give the total value for that labor and improvement to show at least \$100 for each claim). If a geological, geochemical, or geophysical survey was performed, as per 30 U.S.C. 28-1, reference the title of the report of survey, give cost and date of the survey and report, and indicate it was filed with the County Recorder:

Description of Work Performed	Value of Work Performed	Date Work Was Performed
Metal detecting		
Cleaning up trash		
Sampling		

3. Name and mailing address of each person who performed the labor and improvements:

Name (please print)

Russell Williams

Current Mailing Address (please print)

9064 e. gary Ln Mesa Az 85207

4. Name and mailing address of each person who holds and claims the subject mining claim(s) for the valuable minerals contained therein. Be sure to indicate if there is a change of address:

Name (please print)

Current Mailing Address (please print)

\_\_\_\_\_  
 \_\_\_\_\_  
 \_\_\_\_\_  
 \_\_\_\_\_  
 \_\_\_\_\_  
 \_\_\_\_\_  
 \_\_\_\_\_

\_\_\_\_\_  
 \_\_\_\_\_  
 \_\_\_\_\_  
 \_\_\_\_\_  
 \_\_\_\_\_  
 \_\_\_\_\_  
 \_\_\_\_\_

RECEIVED  
 STATE OFFICE  
 2017 DEC 18 P 12:05  
 PHOENIX, ARIZONA

5. The undersigned testifies that on the date of \_\_\_\_\_, 20\_\_\_\_, all monuments required by law were erected upon the subject claim(s), and all notices required by law were posted on the subject claim(s) or copies thereof were in place, and at said date, each corner monument bore or contained

markings sufficient to appropriately designate the corner of the claim to which it pertains and the name of the claim(s).

I hereby certify under penalty of perjury under the laws of the State of Arizona that the foregoing statements are true and correct:

Russell Waller  
(Signature of person responsible for above statement)

Date: 12-18-17

Title 18 U.S.C. 1001 and 43 U.S.C. 1212 make it a crime for any person knowingly and willfully to make to any department or agency of the United States any false, fictitious or fraudulent statements or representations as to any matter within its jurisdiction.

**Notary Block**

SUBSCRIBED AND SWORN TO before me, this 18<sup>th</sup> day of December 2017.

By: Gabriel Bautista-Guzman  
(Signature of Affiant)

Title: Public Notary

My Commission Expires: 10-01-18



**INSTRUCTIONS**

1. This is an optional form that may be used to satisfy the requirements for the Bureau of Land Management (BLM) under the provisions of 43 U.S.C. §1744 and 30 U.S.C. §28-28d and the regulations thereunder (43 CFR part 3835). Since local and State laws may vary, you should contact your local and State agencies where the claims are located to ensure all applicable laws and requirements are satisfied.
2. The claimant(s) must fill in the date in paragraph 1 for the applicable assessment year and the county and state where the claims are located.
3. All claim names, BLM serial numbers, legal descriptions, and original county recording information must be listed for the claims pertaining to this assessment notice.
4. The claimant(s) must complete paragraph 2 listing all labor or improvements which was performed on or did benefit the subject mining claims. The value and date of the labor or improvements must also be listed. The total amount of labor or improvements can be listed, but the total expenditure must equal at least \$100 for each claim.
5. The names and current mailing addresses of the person(s) performing the labor shall be listed in paragraph 3.
6. The name and current mailing address of each owner (claimant) of the claims shall be listed in paragraph 4. The mailing address shall be the owner's address and not the address of an agent or anyone representing the claimant. Be sure to note if there has been a change of address.
7. Paragraph 5 shall be completed to show the date it was verified that all monuments required by law were properly erected, all notices were posted, and that corners were appropriately designated for all claims listed.
8. An exact legible reproduction or duplicate (other than microfilm or other electronic media) of this affidavit or another type of affidavit of assessment work that you file or will file in the county where each claim is located, must be filed with the BLM on or before December 30 of the calendar year in which the assessment year ends. For mill or tunnel sites, a separate notice of intent to hold must be filed with the BLM on or before December 30. Requirements for filing a notice of intent to hold can be found at 43 CFR 3835.33.
9. A processing fee of \$10 for each claim listed must be remitted to the BLM along with this or any other affidavit of assessment work.

RECEIVED  
STATE OFFICE



**United States Department of the Interior**  
**Bureau of Land Management**  
 DIV OF LANDS, MINRLS & ENERGY  
 ONE N CENTRAL AVE  
 PHOENIX, AZ 85004 -4427  
 Phone: 602-417-9200

Receipt

No: 4044421

<b>Transaction #:</b> 4155737	
<b>Date of Transaction:</b> 12/18/2017	
<b>CUSTOMER:</b>	
RUSSELL WILLIAMS 9064 E GARY LN MESA, AZ 85207-4236 US	

LINE #	QTY	DESCRIPTION	REMARKS	UNIT PRICE	TOTAL
1	1.00	LOCATABLE MINERALS / MINING CLAIMS- NOT NEW-UNADJUD, ONE AUTH NO. ONLY / MINING CLAIM MONEY RECEIVED <b>CASES: AMC430614/\$30.00</b>	<i>POL 2017 (3)</i>	- n/a -	30.00
<b>TOTAL:</b>					<b>\$30.00</b>

PAYMENT INFORMATION			
NOTE: Items will appear on credit card statement as "Bureau of Land Mgmt CO".			
1	AMOUNT:	30.00	POSTMARKED: N/A
	TYPE:	CREDIT CARD	RECEIVED: 12/18/2017
	NAME:	WILLIAMS, RUSSELL 9064 E GARY LN MESA AZ 85207-4236 US	
	CARD NO:	XXXXXXXXXXXX1657	AUTH CODE: 07152G
	NAME ON CARD:	RUSSELL F WILLIAMS	
	EXPIRES:	08/2019	
	SIGNATURE:		

REMARKS

This receipt was generated by the automated BLM Collections and Billing System and is a paper representation of a portion of the official electronic record contained therein.



2. Type of labor and improvements (specify what was done and give the total value for that labor and improvement to show at least \$100 for each claim). If a geological, geochemical, or geophysical survey was performed, as per 30 U.S.C. 28-1, reference the title of the report of survey, give cost and date of the survey and report, and indicate it was filed with the County Recorder:

Description of Work Performed	Value of Work Performed	Date Work Was Performed
Cleaning up Trash	\$120 <sup>00</sup>	5/21-8-2018
Metal detecting		
Picking up trash		

3. Name and mailing address of each person who performed the labor and improvements:

Name (please print)

Russell Williams

Current Mailing Address (please print)

9064 e. gary Ln. Mesa Az 85207

4. Name and mailing address of each person who holds and claims the subject mining claim(s) for the valuable minerals contained therein. Be sure to indicate if there is a change of address:

Name (please print)

Russell Williams

Current Mailing Address (please print)

9064 e. gary Ln. Mesa, Az 85207

RECEIVED  
 PHOENIX, ARIZONA  
 2018 AUG 20 A 9:09  
 PHOENIX, ARIZONA  
 PHOENIX, ARIZONA

5. The undersigned testifies that on the date of \_\_\_\_\_, 20\_\_\_\_, all monuments required by law were erected upon the subject claim(s), and all notices required by law were posted on the subject claim(s) or copies thereof were in place, and at said date, each corner monument bore or contained

**AFFIDAVIT OF ANNUAL ASSESSMENT WORK**

WHEN RECORDED, MAIL DOCUMENT TO:

NAME: RUSSEN WILLIAMS

ADDRESS: 9064 E. GARY LN.

CITY, STATE, ZIP: MESA, AZ 85207

FOR COUNTY RECORDER'S USE

No. of Claims 2  
x \$10/claim  
Total due BLM \$ \_\_\_\_\_

TO ALL WHOM IT MAY CONCERN:

1. The undersigned certifies that at least \$100 per claim was expended for development, labor and improvements, or equivalent value added, as the annual assessment work for the assessment year ending September 1, 2018 for the following contiguous unpatented mining claim(s), located in the County of Pinal, in the State of Arizona.

BLM Serial No.	Name of Claim	Tp	Rg	Sec	Mer	County Recordation Book and Page No.	Co. Recording Date
		Example: 13N 5E 14 MDM					
AMC-430614	Two Brothers Gulch	25	16E	23	014		

RECEIVED  
BLM AZ STATE OFFICE  
PHOENIX, ARIZONA  
2019 AUG 20 A 9 09



2. Type of labor and improvements (specify what was done and give the total value for that labor and improvement to show at least \$100 for each claim). If a geological, geochemical, or geophysical survey was performed, as per 30 U.S.C. 28-1, reference the title of the report of survey, give cost and date of the survey and report, and indicate it was filed with the County Recorder:

Description of Work Performed	Value of Work Performed	Date Work Was Performed
Metal detecting	\$125 <sup>00</sup>	Jan-10-2018
Picking up trash		
Sampling		

3. Name and mailing address of each person who performed the labor and improvements:

Name (please print)

Russell Williams

Current Mailing Address (please print)

9004 E. Gary Ln Mesa AZ 85207

4. Name and mailing address of each person who holds and claims the subject mining claim(s) for the valuable minerals contained therein. Be sure to indicate if there is a change of address:

Name (please print)

Current Mailing Address (please print)

RECEIVED  
 IN M A T STATE OFFICE  
 2018 AUG 20 A 9:09  
 PHOENIX, ARIZONA

5. The undersigned testifies that on the date of \_\_\_\_\_, 20\_\_, all monuments required by law were erected upon the subject claim(s), and all notices required by law were posted on the subject claim(s) or copies thereof were in place, and at said date, each corner monument bore or contained

**United States Department of the Interior**  
**Bureau of Land Management**  
 DIV OF LANDS, MINRLS & ENERGY  
 ONE N CENTRAL AVE  
 PHOENIX, AZ 85004 -4427  
 Phone: 602-417-9200

Receipt

No: 4239150

<b>Transaction #:</b> 4354548	
<b>Date of Transaction:</b> 08/20/2018	
CUSTOMER:	
RUSSELL WILLIAMS 9064 E GARY LN MESA, AZ 85207-4236 US	

LINE #	QTY	DESCRIPTION	REMARKS	UNIT PRICE	TOTAL
1	1.00	LOCATABLE MINERALS / MINING CLAIMS-NOT NEW-UNADJUD, ONE AUTH NO. ONLY / MINING CLAIM MONEY RECEIVED CASES: AMC430614/\$20.00	2018 POL AND WAIVER/2	- n/a -	20.00
<b>TOTAL:</b>					<b>\$20.00</b>

PAYMENT INFORMATION					
NOTE: Items will appear on credit card statement as "Bureau of Land Mgmt CO".					
1	AMOUNT:	20.00	POSTMARKED:	N/A	
	TYPE:	CREDIT CARD	RECEIVED:	08/20/2018	
	NAME:	WILLIAMS, RUSSELL 9064 E GARY LN MESA AZ 85207-4236 US			
	CARD NO:	XXXXXXXXXXXX9991	AUTH CODE:	09767G	
	NAME ON CARD:	RUSSELL F WILLIAMS			
	SIGNATURE:				

REMARKS
<i>No expiration date on waiver</i>

This receipt was generated by the automated BLM Collections and Billing System and is a paper representation of a portion of the official electronic record contained therein.

UNITED STATES  
DEPARTMENT OF THE INTERIOR  
BUREAU OF LAND MANAGEMENT

513

EEG

AMC 430614

FORM APPROVED  
OMB NO. 1004-0114

Expires: January 31, 2020

MAINTENANCE FEE WAIVER CERTIFICATION

AMC 417748

SEE INSTRUCTIONS ON PAGE 2

1. This small miner waiver is filed for the assessment year beginning on September 1, 2017 and ending on September 1, 2018.
2. The undersigned and all related parties owned ten or fewer mining claims, mill, or tunnel sites located and maintained on Federal lands in the United States of America on September 1, 2017.
3. The undersigned have performed the assessment work required by law for each mining claim listed prior to filing this waiver and understand that by filing this form, the undersigned must file an affidavit of assessment work with the Bureau of Land Management (BLM) by the December 30th following the filing of this waiver.
4. The undersigned understand that if the assessment work obligation has not yet come due under 30 U.S.C. 28 (for those claims in their first assessment year only), a notice of intent to hold reciting this condition must be recorded by the December 30th following the filing of this waiver.
5. The undersigned understand that mill and tunnel sites may also be listed on this waiver and be waived from payment of the maintenance fee, and that a notice of intent to hold for these sites is required to be filed with the BLM by the December 30th following the filing of this waiver.
6. The undersigned understand and acknowledge that pursuant to 43 U.S.C. 1212 and 18 U.S.C. 1001, the filing or recording of a false, fictitious, or fraudulent document with the BLM may result in a fine of up to \$250,000, a prison term not to exceed five years, or both.
7. The mining claims, mill or tunnel sites for which this waiver from payment of the maintenance fees is requested are:

CLAIM OR SITE NAME	BLM RECORDATION SERIAL NUMBER
1. TWO Brothers Gulch ✓	AMC 430614 L
2. No Clue #1	AMC 417748 L
3. No Clue #2	AMC 417749
4.	
5.	
6.	
7.	
8.	
9.	
10.	

The owner(s) (claimants) of the above mining claims and sites are:

NW check  
2 of  
Russell F. Williams ✓  
(Owner's Name - Please Print)

Russell F. Williams  
(Owner's Signature)

9064 E. Gary Ln.  
(Owner's Mailing Address)

Mesa AZ 85207  
(City) (State) (Zip Code)

Russell F. Williams  
(Owner's Name - Please Print)

Russell F. Williams  
(Owner's Signature)

9064 E. Gary Ln.  
(Owner's Mailing Address)

Mesa AZ 85207  
(City) (State) (Zip Code)

1 of  
one  
Scott Williams  
(Owner's Name - Please Print)

Scott Williams  
(Owner's Signature)

9064 E. Gary Ln.  
(Owner's Mailing Address)

Mesa AZ 85207  
(City) (State) (Zip Code)

NO ADDRESS UPDATE Page according to Brother Russell Scott is at his town Ave address from time to time.

(Owner's Name - Please Print)

(Owner's Signature)

(Owner's Mailing Address)

(City) (State) (Zip Code)

ENTERED  
AC 1183  
SEP 15 2017

(Continued on page 2)

2017 SEP - 1 A 10: 25

RECEIVED  
BLM AZ STATE OFFICE



355

MAINTENANCE FEE WAIVER CERTIFICATION

FORM APPROVED  
OMB NO. 1004-0114  
Expires: October 31, 2016

417748

SEE INSTRUCTIONS ON PAGE 2

- This small miner waiver is filed for the assessment year beginning on September 1, 2016 and ending on September 1, 2017.
- The undersigned and all related parties owned ten or fewer mining claims, mill, or tunnel sites located and maintained on Federal lands in the United States of America on September 1, 2016.
- The undersigned have performed the assessment work required by law for each mining claim listed prior to filing this waiver and understand that by filing this form, the undersigned must file an affidavit of assessment work with the Bureau of Land Management (BLM) by the December 30th following the filing of this waiver.
- The undersigned understand that if the assessment work obligation has not yet come due under 30 U.S.C. 28 (for those claims in their first assessment year only), a notice of intent to hold reciting this condition must be recorded by the December 30th following the filing of this waiver.
- The undersigned understand that mill and tunnel sites may also be listed on this waiver and be waived from payment of the maintenance fee, and that a notice of intent to hold for these sites is required to be filed with the BLM by the December 30th following the filing of this waiver.
- The undersigned understand and acknowledge that pursuant to 43 U.S.C. 1212 and 18 U.S.C. 1001, the filing or recording of a false, fictitious, or fraudulent document with the BLM may result in a fine of up to \$250,000, a prison term not to exceed five years, or both.
- The mining claims, mill or tunnel sites for which this waiver from payment of the maintenance fees is requested are:

CLAIM OR SITE NAME	BLM RECORDATION SERIAL NUMBER
1. No Clue #2	AMEC 417749 ✓
2.	
3.	
4.	
5.	
6.	
7.	
8.	
9.	
10.	

The owner(s) (claimants) of the above mining claims and sites are:

<u>Scott Williams</u> (Owner's Name - Please Print)	<u>Scott Williams</u> (Owner's Signature)
<u>9064 e gary Ln.</u> (Owner's Mailing Address)	<u>Mesa</u> <u>AZ</u> <u>85207</u> (City)                                      (State)                      (Zip Code)
_____ (Owner's Name - Please Print)	_____ (Owner's Signature)
_____ (Owner's Mailing Address)	_____ (City)                                      (State)                      (Zip Code)
_____ (Owner's Name - Please Print)	_____ (Owner's Signature)
_____ (Owner's Mailing Address)	_____ (City)                                      (State)                      (Zip Code)
_____ (Owner's Name - Please Print)	_____ (Owner's Signature)
_____ (Owner's Mailing Address)	_____ (City)                                      (State)                      (Zip Code)

RECEIVED  
 BLM AZ STATE OFFICE  
 2016 AUG 23 A 10:17  
 PHOENIX, ARIZONA

ENTERED  
 SEP 7 2016  
 BY: RE

NL  
 9-7  
 RE



**MAINTENANCE FEE WAIVER CERTIFICATION**

FORM APPROVED  
OMB NO. 1004-0114  
Expires: October 31, 2016

**417748**

SEE INSTRUCTIONS ON PAGE 2

- This small miner waiver is filed for the assessment year beginning on September 1, 2016 and ending on September 1, 2017.
- The undersigned and all related parties owned ten or fewer mining claims, mill, or tunnel sites located and maintained on Federal lands in the United States of America on September 1, 2016.
- The undersigned have performed the assessment work required by law for each mining claim listed prior to filing this waiver and understand that by filing this form, the undersigned must file an affidavit of assessment work with the Bureau of Land Management (BLM) by the December 30th following the filing of this waiver.
- The undersigned understand that if the assessment work obligation has not yet come due under 30 U.S.C. 28 (for those claims in their first assessment year only), a notice of intent to hold reciting this condition must be recorded by the December 30th following the filing of this waiver.
- The undersigned understand that mill and tunnel sites may also be listed on this waiver and be waived from payment of the maintenance fee, and that a notice of intent to hold for these sites is required to be filed with the BLM by the December 30th following the filing of this waiver.
- The undersigned understand and acknowledge that pursuant to 43 U.S.C. 1212 and 18 U.S.C. 1001, the filing or recording of a false, fictitious, or fraudulent document with the BLM may result in a fine of up to \$250,000, a prison term not to exceed five years, or both.
- The mining claims, mill or tunnel sites for which this waiver from payment of the maintenance fees is requested are:

CLAIM OR SITE NAME	BLM RECORDATION SERIAL NUMBER
1. <u>No Clue # 1</u>	<u>Amc417748</u> ✓
2.	
3.	
4.	
5.	
6.	
7.	
8.	
9.	
10.	

The owner(s) (claimants) of the above mining claims and sites are:

Russell Williams

(Owner's Name - Please Print)

9064 E. Gary Ln.

(Owner's Mailing Address)

Russell Williams

(Owner's Signature)

Mesa

(City)

Arizona

(State)

85201

(Zip Code)

(Owner's Name - Please Print)

(Owner's Mailing Address)

(Owner's Signature)

(City)

(State)

(Zip Code)

(Owner's Name - Please Print)

(Owner's Mailing Address)

(Owner's Signature)

(City)

(State)

(Zip Code)

(Owner's Name - Please Print)

(Owner's Mailing Address)

(Owner's Signature)

(City)

(State)

(Zip Code)

(Continued on page 2)

**INTEREST**  
SEP 7 2016  
BY: RE

NL  
9.7  
RE

RECEIVED  
BLM AZ STATE OFFICE  
2016 AUG 23 A 10:37  
PHOENIX, ARIZONA

**AFFIDAVIT OF ANNUAL ASSESSMENT WORK**

417748

430614

WHEN RECORDED, MAIL DOCUMENT TO:

NAME: Russell Williams

ADDRESS: 9064 e. gary

CITY, STATE, ZIP: Mesa, Az 85207

FOR COUNTY RECORDER'S USE

No. of Claims 1

x \$10/claim

Total due BLM \$ \$10<sup>00</sup>

TO ALL WHOM IT MAY CONCERN:

1. The undersigned certifies that at least \$100 per claim was expended for development, labor and improvements, or equivalent value added, as the annual assessment work for the assessment year ending September 1, 2016 for the following contiguous unpatented mining claim(s), located in the County of Maricopa, in the State of Arizona.

BLM Serial No.	Name of Claim	Tp	Rg	Sec	Mer	County Recordation Book and Page No.	Date
AMC 417748	No Claim #1	4N	9W	7	014		8-22-16

RECEIVED  
BLM AZ STATE OFFICE  
2016 AUG 23 A 10:37  
PHOENIX, ARIZONA

2. Type of labor and improvements (specify what was done and give the total value for that labor and improvement to show at least \$100 for each claim). If a geological, geochemical, or geophysical survey was performed, as per 30 U.S.C. 28-1, reference the title of the report of survey, give cost and date of the survey and report, and indicate it was filed with the County Recorder:

Description of Work Performed	Value of Work Performed	Date Work Was Performed
Metal detecting - Sampling - Picking up trash	\$200	Jan-6-16

3. Name and mailing address of each person who performed the labor and improvements:

Name (please print)

Russell Williams  
 \_\_\_\_\_  
 \_\_\_\_\_  
 \_\_\_\_\_

Current Mailing Address (please print)

9064 e. gary Ln Mesa Arizona 8520  
 \_\_\_\_\_  
 \_\_\_\_\_  
 \_\_\_\_\_

4. Name and mailing address of each person who holds and claims the subject mining claim(s) for the valuable minerals contained therein. Be sure to indicate if there is a change of address:

Name (please print)

\_\_\_\_\_  
 \_\_\_\_\_  
 \_\_\_\_\_  
 \_\_\_\_\_  
 \_\_\_\_\_  
 \_\_\_\_\_  
 \_\_\_\_\_

Current Mailing Address (please print)

\_\_\_\_\_  
 \_\_\_\_\_  
 \_\_\_\_\_  
 \_\_\_\_\_  
 \_\_\_\_\_  
 \_\_\_\_\_  
 \_\_\_\_\_

RECEIVED  
 BLM AZ STATE OFFICE  
 2016 AUG 23 A 10: 37  
 PHOENIX, ARIZONA

5. The undersigned testifies that on the date of \_\_\_\_\_, 20\_\_, all monuments required by law were erected upon the subject claim(s), and all notices required by law were posted on the subject claim(s) or copies thereof were in place, and at said date, each corner monument bore or contained

markings sufficient to appropriately designate the corner of the claim which it pertains and the name of the claim(s).

I hereby certify under penalty of perjury under the laws of the State of Arizona that the foregoing statements are true and correct:

Russell Wie Date: 8-22-16  
(Signature of person responsible for above statement)

Title 18 U.S.C. 1001 and 43 U.S.C. 1212 make it a crime for any person knowingly and willfully to make to any department or agency of the United States any false, fictitious or fraudulent statements or representations as to any matter within its jurisdiction.

**Notary Block**

SUBSCRIBED AND SWORN TO before me, this 22nd day of August 2016

By: Amber Luschkowski  
(Signature of Affiant)

Title: Notary Public

My Commission Expires: March 14, 2017

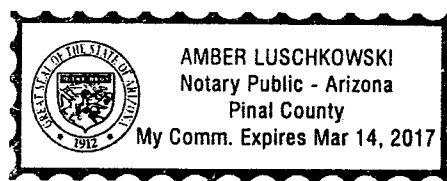

**INSTRUCTIONS**

1. This is an optional form that may be used to satisfy the requirements for the Bureau of Land Management (BLM) under the provisions of 43 U.S.C. §1744 and 30 U.S.C. §28-28d and the regulations thereunder (43 CFR part 3835). Since local and State laws may vary, you should contact your local and State agencies where the claims are located to ensure all applicable laws and requirements are satisfied.
2. The claimant(s) must fill in the date in paragraph 1 for the applicable assessment year and the county and state where the claims are located.
3. All claim names, BLM serial numbers, legal descriptions, and original county recording information must be listed for the claims pertaining to this assessment notice.
4. The claimant(s) must complete paragraph 2 listing all labor or improvements which was performed on or did benefit the subject mining claims. The value and date of the labor or improvements must also be listed. The total amount of labor or improvements can be listed, but the total expenditure must equal at least \$100 for each claim.
5. The names and current mailing addresses of the person(s) performing the labor shall be listed in paragraph 3.
6. The name and current mailing address of each owner (claimant) of the claims shall be listed in paragraph 4. The mailing address shall be the owner's address and not the address of an agent or anyone representing the claimant. Be sure to note if there has been a change of address.
7. Paragraph 5 shall be completed to show the date it was verified that all monuments required by law were properly erected, all notices were posted, and that corners were appropriately designated for all claims listed.
8. An exact legible reproduction or duplicate (other than microfilm or other electronic media) of this affidavit or another type of affidavit of assessment work that you file or will file in the county where each claim is located, must be filed with the BLM on or before December 30 of the calendar year in which the assessment year ends. For mill or tunnel sites, a separate notice of intent to hold must be filed with the BLM on or before December 30. Requirements for filing a notice of intent to hold can be found at 43 CFR 3835.33.
9. A processing fee of \$10 for each claim listed must be remitted to the BLM along with this or any other affidavit of assessment work.

RECEIVED  
BLM AZ STATE OFFICE  
AUG 23 10:37



**AFFIDAVIT OF ANNUAL ASSESSMENT WORK**

WHEN RECORDED, MAIL DOCUMENT TO:

NAME: Scott Williams

ADDRESS: 9064 E Gary Ln.

CITY, STATE, ZIP: Mesa, Az. 85207

FOR COUNTY RECORDER'S USE

No. of Claims 1

x \$10/claim

Total due BLM \$ \$10<sup>00</sup>

TO ALL WHOM IT MAY CONCERN:

- The undersigned certifies that at least \$100 per claim was expended for development, labor and improvements, or equivalent value added, as the annual assessment work for the assessment year ending September 1, 2016 for the following contiguous unpatented mining claim(s), located in the County of Maricopa, in the State of Arizona.

BLM Serial No.	Name of Claim	Tp	Rg	Sec	Mer	County Recordation Book and Page No.	Date
AMC417749	No. Claim #2	4N	9W	7	014		8-22-16

RECEIVED  
BLM AZ STATE OFFICE  
2016 AUG 23 A 10:37  
PHOENIX, ARIZONA

2. Type of labor and improvements (specify what was done and give the total value for that labor and improvement to show at least \$100 for each claim). If a geological, geochemical, or geophysical survey was performed, as per 30 U.S.C. 28-1, reference the title of the report of survey, give cost and date of the survey and report, and indicate it was filed with the County Recorder:

Description of Work Performed	Value of Work Performed	Date Work Was Performed
Metal detecting - Sampling - Picking up Trash	\$200 <sup>00</sup>	Sun 6-16

3. Name and mailing address of each person who performed the labor and improvements:

Name (please print)

Scott Williams  
 \_\_\_\_\_  
 \_\_\_\_\_  
 \_\_\_\_\_

Current Mailing Address (please print)

9064 E Gary Ln  
 Mesa, AZ 85207  
 \_\_\_\_\_  
 \_\_\_\_\_

4. Name and mailing address of each person who holds and claims the subject mining claim(s) for the valuable minerals contained therein. Be sure to indicate if there is a change of address:

Name (please print)

\_\_\_\_\_  
 \_\_\_\_\_  
 \_\_\_\_\_  
 \_\_\_\_\_  
 \_\_\_\_\_  
 \_\_\_\_\_

Current Mailing Address (please print)

\_\_\_\_\_  
 \_\_\_\_\_  
 \_\_\_\_\_  
 \_\_\_\_\_  
 \_\_\_\_\_  
 \_\_\_\_\_

RECEIVED  
 BLM AZ STATE OFFICE  
 2016 AUG 23 A 10:37  
 PHOENIX, ARIZONA

5. The undersigned testifies that on the date of \_\_\_\_\_, 20\_\_\_\_, all monuments required by law were erected upon the subject claim(s), and all notices required by law were posted on the subject claim(s) or copies thereof were in place, and at said date, each corner monument bore or contained

markings sufficient to appropriately designate the corner of the claim to which it pertains and the name of the claim(s).

I hereby certify under penalty of perjury under the laws of the State of Arizona that the foregoing statements are true and correct:

Scott G. Williams Date: 8/22/16  
(Signature of person responsible for above statement)

Title 18 U.S.C. 1001 and 43 U.S.C. 1212 make it a crime for any person knowingly and willfully to make to any department or agency of the United States any false, fictitious or fraudulent statements or representations as to any matter within its jurisdiction.

**Notary Block**

SUBSCRIBED AND SWORN TO before me, this 22nd day of August 20 16

By: Amber Luschkowski  
(Signature of Affiant)

Title: Notary Public

My Commission Expires: March 14, 2017

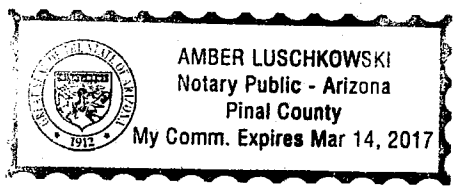

**INSTRUCTIONS**

1. This is an optional form that may be used to satisfy the requirements for the Bureau of Land Management (BLM) under the provisions of 43 U.S.C. §1744 and 30 U.S.C. §28-28d and the regulations thereunder (43 CFR part 3835). Since local and State laws may vary, you should contact your local and State agencies where the claims are located to ensure all applicable laws and requirements are satisfied.
2. The claimant(s) must fill in the date in paragraph 1 for the applicable assessment year and the county and state where the claims are located.
3. All claim names, BLM serial numbers, legal descriptions, and original county recording information must be listed for the claims pertaining to this assessment notice.
4. The claimant(s) must complete paragraph 2 listing all labor or improvements which was performed on or did benefit the subject mining claims. The value and date of the labor or improvements must also be listed. The total amount of labor or improvements can be listed, but the total expenditure must equal at least \$100 for each claim.
5. The names and current mailing addresses of the person(s) performing the labor shall be listed in paragraph 3.
6. The name and current mailing address of each owner (claimant) of the claims shall be listed in paragraph 4. The mailing address shall be the owner's address and not the address of an agent or anyone representing the claimant. Be sure to note if there has been a change of address.
7. Paragraph 5 shall be completed to show the date it was verified that all monuments required by law were properly erected, all notices were posted, and that corners were appropriately designated for all claims listed.
8. An exact legible reproduction or duplicate (other than microfilm or other electronic media) of this affidavit or another type of affidavit of assessment work that you file or will file in the county where each claim is located, must be filed with the BLM on or before December 30 of the calendar year in which the assessment year ends. For mill or tunnel sites, a separate notice of intent to hold must be filed with the BLM on or before December 30. Requirements for filing a notice of intent to hold can be found at 43 CFR 3835.93.
9. A processing fee of \$10 for each claim listed must be remitted to the BLM along with this or any other affidavit of assessment work.

RECEIVED  
BLM AZ STATE OFFICE  
2016 AUG 23 A 10:37

**AFFIDAVIT OF ANNUAL ASSESSMENT WORK**

WHEN RECORDED, MAIL DOCUMENT TO:

NAME: Russell Williams

ADDRESS: 9064 e. gary Ln.

CITY, STATE, ZIP: Mesa, Az 85207

FOR COUNTY RECORDER'S USE

No. of Claims 1

x \$10/claim

Total due BLM \$ #10

TO ALL WHOM IT MAY CONCERN:

1. The undersigned certifies that at least \$100 per claim was expended for development, labor and improvements, or equivalent value added, as the annual assessment work for the assessment year ending September 1, 2016 for the following contiguous unpatented mining claim(s), located in the County of Pinal, in the State of Arizona.

BEM Serial No.	Name of Claim	Tp	Rg	Sec	Mer	County Recordation Book and Page No.	Date
AMC 43064	Two Brothers Gulch	2S	11E	23	014		Jan-2-2016

RECEIVED  
BLM AZ STATE OFFICE  
2016 AUG 23 A 10: 37  
PHOENIX, ARIZONA



2. Type of labor and improvements (specify what was done and give the total value for that labor and improvement to show at least \$100 for each claim). If a geological, geochemical, or geophysical survey was performed, as per 30 U.S.C. 28-1, reference the title of the report of survey, give cost and date of the survey and report, and indicate it was filed with the County Recorder:

Description of Work Performed	Value of Work Performed	Date Work Was Performed
Metal detecting - picking up trash	\$160 <sup>00</sup>	Feb-3-2016
Metal detecting		
Sampling		

3. Name and mailing address of each person who performed the labor and improvements:

Name (please print)

Russell Williams

Current Mailing Address (please print)

9064 e. Gary Ln. Mesa Az 85207

4. Name and mailing address of each person who holds and claims the subject mining claim(s) for the valuable minerals contained therein. Be sure to indicate if there is a change of address:

Name (please print)

\_\_\_\_\_  
 \_\_\_\_\_  
 \_\_\_\_\_  
 \_\_\_\_\_  
 \_\_\_\_\_  
 \_\_\_\_\_

Current Mailing Address (please print)

\_\_\_\_\_  
 \_\_\_\_\_  
 \_\_\_\_\_  
 \_\_\_\_\_  
 \_\_\_\_\_  
 \_\_\_\_\_

RECEIVED  
 BLM AZ STATE OFFICE  
 2016 AUG 23 A 10:37  
 PHOENIX, ARIZONA

5. The undersigned testifies that on the date of \_\_\_\_\_, 20\_\_, all monuments required by law were erected upon the subject claim(s), and all notices required by law were posted on the subject claim(s) or copies thereof were in place, and at said date, each corner monument bore or contained

markings sufficient to appropriately designate the corner of the claim      which it pertains and the name of the claim(s).

I hereby certify under penalty of perjury under the laws of the State of Arizona that the foregoing statements are true and correct:

Russell Williams Date: 8-22-16  
(Signature of person responsible for above statement)

Title 18 U.S.C. 1001 and 43 U.S.C. 1212 make it a crime for any person knowingly and willfully to make to any department or agency of the United States any false, fictitious or fraudulent statements or representations as to any matter within its jurisdiction.

**Notary Block**

SUBSCRIBED AND SWORN TO before me, this 22nd day of August 2016

By: Amber Luschkowski  
(Signature of Affiant)

Title: Notary Public

My Commission Expires: March 14, 2017

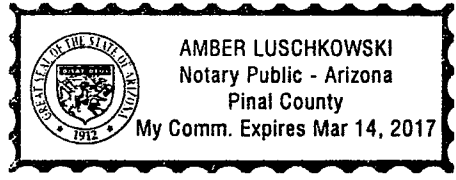

**INSTRUCTIONS**

1. This is an optional form that may be used to satisfy the requirements for the Bureau of Land Management (BLM) under the provisions of 43 U.S.C. §1744 and 30 U.S.C. §28-28d and the regulations thereunder (43 CFR part 3835). Since local and State laws may vary, you should contact your local and State agencies where the claims are located to ensure all applicable laws and requirements are satisfied.
2. The claimant(s) must fill in the date in paragraph 1 for the applicable assessment year and the county and state where the claims are located.
3. All claim names, BLM serial numbers, legal descriptions, and original county recording information must be listed for the claims pertaining to this assessment notice.
4. The claimant(s) must complete paragraph 2 listing all labor or improvements which was performed on or did benefit the subject mining claims. The value and date of the labor or improvements must also be listed. The total amount of labor or improvements can be listed, but the total expenditure must equal at least \$100 for each claim.
5. The names and current mailing addresses of the person(s) performing the labor shall be listed in paragraph 3.
6. The name and current mailing address of each owner (claimant) of the claims shall be listed in paragraph 4. The mailing address shall be the owner's address and not the address of an agent or anyone representing the claimant. Be sure to note if there has been a change of address.
7. Paragraph 5 shall be completed to show the date it was verified that all monuments required by law were properly erected, all notices were posted, and that corners were appropriately designated for all claims listed.
8. An exact legible reproduction or duplicate (other than microfilm or other electronic media) of this affidavit or another type of affidavit of assessment work that you file or will file in the county where each claim is located, must be filed with the BLM on or before December 30 of the calendar year in which the assessment year ends. For mill or tunnel sites, a separate notice of intent to hold must be filed with the BLM on or before December 30. Requirements for filing a notice of intent to hold can be found in 43 CFR 3835.33.
9. A processing fee of \$10 for each claim listed must be remitted to the BLM along with this or any other affidavit of assessment work.

2016 AUG 23 A 10:38  
RECEIVED  
BLM AZ STATE OFFICE

**United States Department of the Interior  
Bureau of Land Management**  
DIV OF LANDS, MINRLS & ENERGY  
ONE N CENTRAL AVE  
PHOENIX, AZ 85004 -4427  
Phone: 602-417-9200

Receipt

No: 3638147

<b>Transaction #:</b> 3742045	
<b>Date of Transaction:</b> 08/23/2016	
CUSTOMER:	
RUSSELL WILLIAMS 9064 E GARY LN MESA, AZ 85207-4236 US	

LINE #	QTY	DESCRIPTION	REMARKS	UNIT PRICE	TOTAL
1	1.00	LOCATABLE MINERALS / MINING CLAIMS- NOT NEW-UNADJUD, ONE AUTH NO. ONLY / MINING CLAIM MONEY RECEIVED <b>CASES: AMC417748/\$30.00</b>	POL 2016/3 WAV	- n/a -	30.00
<b>TOTAL:</b>					<b>\$30.00</b>

PAYMENT INFORMATION			
NOTE: Items will appear on credit card statement as "Bureau of Land Mgmt CO".			
1	AMOUNT:	30.00	POSTMARKED: N/A
	TYPE:	CREDIT CARD	RECEIVED: 08/23/2016
	NAME:	WILLIAMS, RUSSELL 9064 E GARY LN MESA AZ 85207-4236 US	
	CARD NO:	XXXXXXXXXXXX6096	AUTH CODE: 05507G
	NAME ON CARD:	RUSSELL F WILLIAMS	
	EXPIRES:	08/2019	
	SIGNATURE:		

REMARKS

This receipt was generated by the automated BLM Collections and Billing System and is a paper representation of a portion of the official electronic record contained therein.

**ENTERED**  
**AUG 24 2016**  
BY: 

UNITED STATES  
DEPARTMENT OF THE INTERIOR  
BUREAU OF LAND MANAGEMENT

**MAINTENANCE FEE WAIVER CERTIFICATION**

13651

*Corrected Waiver*

417748  
FORM APPROVED  
OMB NO. 1004-0114  
Expires: October 31, 2016

SEE INSTRUCTIONS ON PAGE 2

1. This small miner waiver is filed for the assessment year beginning on September 1, 2015 and ending on September 1, 2016.
2. The undersigned and all related parties owned ten or fewer mining claims, mill, or tunnel sites located and maintained on Federal lands in the United States of America on September 1, 2015.
3. The undersigned have performed the assessment work required by law for each mining claim listed prior to filing this waiver and understand that by filing this form, the undersigned must file an affidavit of assessment work with the Bureau of Land Management (BLM) by the December 30th following the filing of this waiver.
4. The undersigned understand that if the assessment work obligation has not yet come due under 30 U.S.C. 28 (for those claims in their first assessment year only), a notice of intent to hold reciting this condition must be recorded by the December 30th following the filing of this waiver.
5. The undersigned understand that mill and tunnel sites may also be listed on this waiver and be waived from payment of the maintenance fee, and that a notice of intent to hold for these sites is required to be filed with the BLM by the December 30th following the filing of this waiver.
6. The undersigned understand and acknowledge that pursuant to 43 U.S.C. 1212 and 18 U.S.C. 1001, the filing or recording of a false, fictitious, or fraudulent document with the BLM may result in a fine of up to \$250,000, a prison term not to exceed five years, or both.
7. The mining claims, mill or tunnel sites for which this waiver from payment of the maintenance fees is requested are:

CLAIM OR SITE NAME	BLM RECORDATION SERIAL NUMBER
1. <u>No clue #1</u>	<u>AMC 417748</u>
2.	
3.	
4.	
5.	
6.	
7.	
8.	
9.	
10.	

RECEIVED  
BLM AZ STATE OFFICE  
2015 OCT - 2 P 3:08  
PHOENIX, ARIZONA

The owner(s) (claimants) of the above mining claims and sites are:

Russell Williams  
(Owner's Name - Please Print) ✓  
9064 E. Gary Ln.  
(Owner's Mailing Address)

Russell Wise  
(Owner's Signature)  
Mesa AZ 85207  
(City) (State) (Zip Code)

\_\_\_\_\_  
(Owner's Name - Please Print)  
\_\_\_\_\_  
(Owner's Mailing Address)

\_\_\_\_\_  
(Owner's Signature)  
\_\_\_\_\_  
(City) (State) (Zip Code)

\_\_\_\_\_  
(Owner's Name - Please Print)  
\_\_\_\_\_  
(Owner's Mailing Address)

2016  
"WVR CURED"  
- AC 247 Removed  
OCT 05 2015  
\_\_\_\_\_  
(City) PB (State) (Zip Code)

\_\_\_\_\_  
(Owner's Name - Please Print)  
\_\_\_\_\_  
(Owner's Mailing Address)

\_\_\_\_\_  
(Owner's Signature)  
\_\_\_\_\_  
(City) (State) (Zip Code)



(Owner's Name - Please Print)	(Owner's Signature)
(Owner's Mailing Address)	(City) (State) (Zip Code)
(Owner's Name - Please Print)	(Owner's Signature)
(Owner's Mailing Address)	(City) (State) (Zip Code)
(Owner's Name - Please Print)	(Owner's Signature)
(Owner's Mailing Address)	(City) (State) (Zip Code)
(Owner's Name - Please Print)	(Owner's Signature)
(Owner's Mailing Address)	(City) (State) (Zip Code)

18 U.S.C. 1001 and 43 U.S.C. 1212 make it a crime for any person knowingly and willfully to make to any department or agency of the United States any false, fictitious or fraudulent statements or representations as to any matter within its jurisdiction.

**INSTRUCTIONS**

1. This certification is made under the provisions of 43 U.S.C. § 1744 and 30 U.S.C. §28-28k and the regulations thereunder (43 CFR Part 3830).
2. The claimant(s) must fill in the dates in paragraph 1 for the beginning and ending of the assessment year for which this waiver is sought.
3. The claimant(s) must fill in the date in paragraph 2 for the beginning of the assessment year for which this waiver is sought.
4. All claim and site names and BLM serial numbers must be listed for the mining claims, mill sites, and tunnel sites for which the waiver is sought.
5. All owners of the mining claims, mill sites, and tunnel sites and their addresses must be given.
6. This waiver form must be signed by all the claimants or their designated agent, in original form. If an agent is designated, a notarized designation of agent, signed by all of the claimants with proper address given, must be submitted with this waiver.
7. This form must be filed no later than September 1st for the upcoming assessment year in the BLM State Office where the mining claims or sites are recorded, or the waiver cannot be granted by the BLM. (Example: To obtain a waiver for the assessment year 2012, which begins on September 1, 2011, you must qualify for and file for a waiver no later than September 1, 2011, in the proper BLM State Office.)
8. For all mining claims which require assessment work, you must record an affidavit of labor on or before the December 30th immediately following the filing of this waiver. For all other mining claims or sites waived, you must record a notice of intent to hold on or before the December 30th immediately following the filing of this waiver.
9. Mill and tunnel sites may also be listed on this waiver and be waived from payment of the maintenance fee. A notice of intent to hold for these sites is required to be filed by the December 30th following the filing of this waiver.

OCT 02 2012

**FOR OFFICIAL USE ONLY**

## NOTICES

The Privacy Act and 43 CFR 2.48(d) require that you be furnished the following information in connection with the information requested by this form.

**AUTHORITY:** 30 U.S.C. 28f and 43 CFR part 3835 permit collection of the information requested by this form.

**PRINCIPAL PURPOSE:** The BLM will use the information you provide to verify that the owner(s) (claimants(s)) of a mining claim has/have complied with 30 U.S.C. 28f and 43 CFR part 3835 and is/are entitled to perform assessment work in lieu of paying the maintenance fee for the mining claims listed on this form.

**ROUTINE USES:** The BLM will only disclose this information in accordance with the provisions at 43 CFR 2.56(b) and (c).

**EFFECT OF NOT PROVIDING INFORMATION:** Disclosure of the requested information is required by 30 U.S.C. 28f and 43 CFR part 3835 for those claimants qualified to request the small miner waiver allowed. Failure to submit all the requested information or to complete this form will delay the BLM's processing of the form and may preclude the BLM's acceptance of the maintenance fee waiver request, which may result in forfeiture of the mining claim or site by the claimant.

The Paperwork Reduction Act requires us to inform you that:

The BLM collects this information to determine whether or not you are qualified for waiver of maintenance fees.

Submission of the requested information is necessary to obtain or retain a benefit.

You do not have to respond to this or any other Federal agency-sponsored information collection unless it displays a currently valid OMB control number.

**BURDEN HOURS STATEMENT:** Public reporting burden for this form is estimated to average 20 minutes per response, including the time for reviewing instructions, gathering and maintaining data, and completing and reviewing the form. You may submit comments regarding the burden estimate or any other aspect of this form to: U.S. Department of the Interior, Bureau of Land Management (1004-0114), Bureau Information Collection Clearance Officer (WO-630), Mail Stop 401 LS, 1849 C St., N.W., Washington, D.C. 20240.

RECEIVED  
BLM AZ STATE OFFICE  
2015 OCT -2 P 3:08  
PHOENIX, ARIZONA



UNITED STATES  
DEPARTMENT OF THE INTERIOR  
BUREAU OF LAND MANAGEMENT  
**MAINTENANCE FEE WAIVER CERTIFICATION**

*Corrected Waiver*

417748  
FORM APPROVED  
OMB NO. 1004-0114  
Expires: October 31, 2016

**306**

SEE INSTRUCTIONS ON PAGE 2

1. This small miner waiver is filed for the assessment year beginning on September 1, 2015 and ending on September 1, 2016.
2. The undersigned and all related parties owned ten or fewer mining claims, mill, or tunnel sites located and maintained on Federal lands in the United States of America on September 1, 2015.
3. The undersigned have performed the assessment work required by law for each mining claim listed prior to filing this waiver and understand that by filing this form, the undersigned must file an affidavit of assessment work with the Bureau of Land Management (BLM) by the December 30th following the filing of this waiver.
4. The undersigned understand that if the assessment work obligation has not yet come due under 30 U.S.C. 28 (for those claims in their first assessment year only), a notice of intent to hold reciting this condition must be recorded by the December 30th following the filing of this waiver.
5. The undersigned understand that mill and tunnel sites may also be listed on this waiver and be waived from payment of the maintenance fee, and that a notice of intent to hold for these sites is required to be filed with the BLM by the December 30th following the filing of this waiver.
6. The undersigned understand and acknowledge that pursuant to 43 U.S.C. 1212 and 18 U.S.C. 1001, the filing or recording of a false, fictitious, or fraudulent document with the BLM may result in a fine of up to \$250,000, a prison term not to exceed five years, or both.
7. The mining claims, mill or tunnel sites for which this waiver from payment of the maintenance fees is requested are:

CLAIM OR SITE NAME	BLM RECORDATION SERIAL NUMBER
1. <u>No Clue #2</u>	<u>AMC 417749</u>
2.	
3.	
4.	
5.	
6.	
7.	
8.	
9.	
10.	

RECEIVED  
BLM AT STATE OFFICE  
2015 OCT -2 P 3:07  
PHOENIX, ARIZONA

The owner(s) (claimants) of the above mining claims and sites are:

Scott Williams ✓  
(Owner's Name - Please Print)

Scott Williams  
(Owner's Signature)

7916 E Irwin Ave  
(Owner's Mailing Address)

Mesa AZ 85209  
(City) (State) (Zip Code)

ENTERED OCT 06 2015  
(AC170) PB

(Owner's Name - Please Print)

(Owner's Signature)

(Owner's Mailing Address)

2016 Waiver  
(City) (State) (Zip Code)

(Owner's Name - Please Print)

Corrected Remove  
OCT 05 2015 AC247  
PB (Owner's Signature)

(Owner's Mailing Address)

(City) (State) (Zip Code)

(Owner's Name - Please Print)

(Owner's Signature)

(Owner's Mailing Address)

(City) (State) (Zip Code)

\_\_\_\_\_  
(Owner's Name - Please Print)

\_\_\_\_\_  
(Owner's Signature)

\_\_\_\_\_  
(Owner's Mailing Address)

\_\_\_\_\_  
(City)

\_\_\_\_\_  
(State)

\_\_\_\_\_  
(Zip Code)

\_\_\_\_\_  
(Owner's Name - Please Print)

\_\_\_\_\_  
(Owner's Signature)

\_\_\_\_\_  
(Owner's Mailing Address)

\_\_\_\_\_  
(City)

\_\_\_\_\_  
(State)

\_\_\_\_\_  
(Zip Code)

\_\_\_\_\_  
(Owner's Name - Please Print)

\_\_\_\_\_  
(Owner's Signature)

\_\_\_\_\_  
(Owner's Mailing Address)

\_\_\_\_\_  
(City)

\_\_\_\_\_  
(State)

\_\_\_\_\_  
(Zip Code)

\_\_\_\_\_  
(Owner's Name - Please Print)

\_\_\_\_\_  
(Owner's Signature)

\_\_\_\_\_  
(Owner's Mailing Address)

\_\_\_\_\_  
(City)

\_\_\_\_\_  
(State)

\_\_\_\_\_  
(Zip Code)

18 U.S.C. 1001 and 43 U.S.C. 1212 make it a crime for any person knowingly and willfully to make to any department or agency of the United States any false, fictitious or fraudulent statements or representations as to any matter within its jurisdiction.

INSTRUCTIONS

1. This certification is made under the provisions of 43 U.S.C. § 1744 and 30 U.S.C. §28-28k and the regulations thereunder (43 CFR Part 3830).
2. The claimant(s) must fill in the dates in paragraph 1 for the beginning and ending of the assessment year for which this waiver is sought.
3. The claimant(s) must fill in the date in paragraph 2 for the beginning of the assessment year for which this waiver is sought.
4. All claim and site names and BLM serial numbers must be listed for the mining claims, mill sites, and tunnel sites for which the waiver is sought.
5. All owners of the mining claims, mill sites, and tunnel sites and their addresses must be given.
6. This waiver form must be signed by all the claimants or their designated agent, in original form. If an agent is designated, a notarized designation of agent, signed by all of the claimants with proper address given, must be submitted with this waiver.
7. This form must be filed no later than September 1st for the upcoming assessment year in the BLM State Office where the mining claims or sites are recorded, or the waiver cannot be granted by the BLM. (Example: To obtain a waiver for the assessment year 2012, which begins on September 1, 2011, you must qualify for and file for a waiver no later than September 1, 2011, in the proper BLM State Office.)
8. For all mining claims which require assessment work, you must record an affidavit of labor on or before the December 30th immediately following the filing of this waiver. For all other mining claims or sites waived, you must record a notice of intent to hold on or before the December 30th immediately following the filing of this waiver.
9. Mill and tunnel sites may also be listed on this waiver and be waived from payment of the maintenance fee. A notice of intent to hold for these sites is required to be filed by the December 30th following the filing of this waiver.

FOR OFFICIAL USE ONLY



Russell Williams  
9064 E Gary  
Mesa, AZ 85207

PHOENIX AZ 852

30 SEP 2015 PM 4 L



RECEIVED  
DLM AZ STATE OFFICE

2015 OCT -2 P 3:05

PHOENIX, ARIZONA

Bureau of Land Management  
Arizona State Office  
1 North Central Avenue, Suite 800  
Phoenix, AZ 85004

85004442700



NOTICES

The Privacy Act and 43 CFR 2.48(d) require that you be furnished the following information in connection with the information requested by this form.

AUTHORITY: 30 U.S.C. 28f and 43 CFR part 3835 permit collection of the information requested by this form.

PRINCIPAL PURPOSE: The BLM will use the information you provide to verify that the owner(s) (claimants(s)) of a mining claim has/have complied with 30 U.S.C. 28f and 43 CFR part 3835 and is/are entitled to perform assessment work in lieu of paying the maintenance fee for the mining claims listed on this form.

ROUTINE USES: The BLM will only disclose this information in accordance with the provisions at 43 CFR 2.56(b) and (c).

EFFECT OF NOT PROVIDING INFORMATION: Disclosure of the requested information is required by 30 U.S.C. 28f and 43 CFR part 3835 for those claimants qualified to request the small miner waiver allowed. Failure to submit all the requested information or to complete this form will delay the BLM's processing of the form and may preclude the BLM's acceptance of the maintenance fee waiver request, which may result in forfeiture of the mining claim or site by the claimant.

The Paperwork Reduction Act requires us to inform you that:

The BLM collects this information to determine whether or not you are qualified for waiver of maintenance fees.

Submission of the requested information is necessary to obtain or retain a benefit.

You do not have to respond to this or any other Federal agency-sponsored information collection unless it displays a currently valid OMB control number.

**BURDEN HOURS STATEMENT:** Public reporting burden for this form is estimated to average 20 minutes per response, including the time for reviewing instructions, gathering and maintaining data, and completing and reviewing the form. You may submit comments regarding the burden estimate or any other aspect of this form to: U.S. Department of the Interior, Bureau of Land Management (1004-0114), Bureau Information Collection Clearance Officer (WO-630), Mail Stop 401 LS, 1849 C St., N.W., Washington, D.C. 20240.

RECEIVED  
BLM AZ STATE OFFICE  
2015 OCT -2 P 3: 08  
PHOENIX, ARIZONA

### Customer Name Update Screen

System ID:MC

Name: WILLIAMS SCOTT

Lookup

Proprietor #: 2337446

Renumber To:

Category: P - PRIVATE

Address: 7916 E IRWIN AVE

City: MESA

State: AZ

Zip: 852094256

UNDELIVERABLE

Email:

Phone:

*Address Updated*  
**ENTERED OCT 06 2015**  
*(Ac 170) Entered PB*

Save Save/Override DataFlux

Delete Renumber

Customer details successfully saved for Customer Id 2337446

# Customer Name Update Screen

System ID:MC

Name: WILLIAMS SCOTT

Lookup

Proprietor #: 2337446

*AK 170*  
ENTERED OCT 06 2015

Renumber To:

Category: P - PRIVATE

*Previous Address*

Address: 9064 E GARY LN

City: MESA

State: AZ

Zip: 852074236

UNDELIVERABLE

Email:

Phone:

Save

Save/Override DataFlux

Delete

Renumber

ENTERED OCT 08 2015



DEPARTMENT OF THE INTERIOR  
BUREAU OF LAND MANAGEMENT  
MINING CLAIMS

MC Customer Information - With Serial No. and Claim Name  
ACTIVE CLAIMS

Admin State: AZ

Geo State: AZ

WILLIAMS SCOTT  
9064 E GARY LN  
MESA, AZ 85207-4236

CUSTOMER ID: 2337446

<u>Serial No.</u>	<u>Claim Name/Number</u>	<u>Lead Serial No.</u>	<u>Disposition</u>
AMC417749	NO CLUE #2	AMC417748	ACTIVE

Number of ACTIVE cases: 1

**BUREAU OF LAND MANAGEMENT**  
**MINING CLAIMS**  
**MC Customer Information**

Run Date: 10/06/2015 08:29 AM

Page: 1

Total Rows Returned: 1

AZ

**Limiting Criteria:**

---

System Id = MC

Admin State = AZ

Geo State = AZ

Case Disp Txt = ACTIVE

Geost County Cd =

Admst Dist FO Cd =

Cust Nm begins with WILLIAMS SCOTT

District Txt =

FO Txt =

County Txt =

Adm Agency =

Adm Agency Txt =

Mer Twp Rng =

Mtrs =

Casetype =

**NO WARRANTY IS MADE BY BLM  
FOR USE OF THE DATA FOR  
PURPOSES NOT INTENDED BY BLM**

**DEPARTMENT OF THE INTERIOR  
BUREAU OF LAND MANAGEMENT  
MINING CLAIMS**

**(LIVE) Serial Register Page**

Run Date/Time: 10/05/2015 05:04 PM

Page 1 of 1

01 10-21-1976;090STAT0090;43USC1744  
Case Type 384201: PLACER CLAIM  
Claim Name: NO CLUE #1  
Commodity :  
Case Disposition: ACTIVE  
Required Maintenance Fee: \$155.00

Total Acres  
20.000

Serial Number  
AMC417748  
Lead File Number  
AMC417748

Name & Address	Int Rel
WILLIAMS RUSSELL ✓ 9064 E GARY LN MESA, AZ 85207-4236	CLAIMANT

Mer Twp	Rng	Sec	Quadrant	District/Field Office	County
14	0040N	0090W	007 NE	HASSAYAMPA FO	MARICOPA

Act Date	Code	Action	Action Remarks	Receipt Number
09/01/2012	403	LOCATION DATE		
10/09/2012	395	RECORDATION NOTICE RECD	1	2668338
08/19/2015	483	SMALL MINER CERT FILED	2016	
08/19/2015	480	EVID OF ASSMT FILED	2015	3370789
08/21/2014	483	SMALL MINER CERT FILED	2015	
08/21/2014	480	EVID OF ASSMT FILED	2014	3108032
08/21/2013	483	SMALL MINER CERT FILED	2014	
10/09/2012	484	LOCATION YEAR / MAINTENANCE	2013;\$140	2668338
08/21/2013	481	NOTICE OF INTENT TO HOLD	2013	2861022
08/19/2015	247	FUTURE ACTION SUSPENSE	2016 WVR CORRECTION	
05/06/2013	669	LAND STATUS CHECKED		
10/09/2012	501	ACCT ADV IN LEAD FILE	AMC417748-AMC417749;	

Line Nr Remarks

**DEPARTMENT OF THE INTERIOR  
BUREAU OF LAND MANAGEMENT  
MINING CLAIMS**

**(LIVE) Serial Register Page**

Run Date/Time: 10/06/2015 08:38 AM

Page 1 of 1

01 10-21-1976;090STAT0090;43USC1744  
Case Type 384201: PLACER CLAIM  
Claim Name: NO CLUE #2  
Commodity :  
Case Disposition: ACTIVE  
Required Maintenance Fee: \$155.00

Total Acres  
20.000

Serial Number  
AMC417749  
Lead File Number  
AMC417748

*Address Updated*  
**ENTERED OCT 06 2015**

Name & Address

WILLIAMS SCOTT

7916 E IRWIN AVE ✓

MESA, AZ 85209-4256

Int Rel

CLAIMANT

Mer Twp	Rng	Sec	Quadrant	District/Field Office	County
14	0040N	0090W	008 NW	HASSAYAMPA FO	MARICOPA

Act Date	Code	Action	Action Remarks	Receipt Number
09/01/2012	403	LOCATION DATE		
10/09/2012	395	RECORDATION NOTICE RECD	1	2668338
08/19/2015	483	SMALL MINER CERT FILED	2016	
08/19/2015	480	EVID OF ASSMT FILED	2015	3370789
08/21/2014	483	SMALL MINER CERT FILED	2015	
08/21/2014	480	EVID OF ASSMT FILED	2014	3108032
08/21/2013	483	SMALL MINER CERT FILED	2014	
10/09/2012	484	LOCATION YEAR / MAINTENANCE	2013;\$140	2668338
08/21/2013	481	NOTICE OF INTENT TO HOLD	2013	2861022
10/02/2015	170	ADDRESS CHANGE FILED	SCOTT WILLIAMS	
05/06/2013	669	LAND STATUS CHECKED		
10/09/2012	501	ACCT ADV IN LEAD FILE	AMC417748-AMC417749;	

Line Nr Remarks



DEPARTMENT OF THE INTERIOR  
BUREAU OF LAND MANAGEMENT  
MINING CLAIMS

(LIVE) Serial Register Page

Run Date/Time: 10/05/2015 05:05 PM

Page 1 of 1

01 10-21-1976;090STAT0090;43USC1744  
Case Type 384201: PLACER CLAIM  
Claim Name: NO CLUE #2  
Commodity :  
Case Disposition: ACTIVE  
Required Maintenance Fee: \$155.00

Total Acres  
20.000

Serial Number  
AMC417749  
Lead File Number  
AMC417748

Name & Address

WILLIAMS SCOTT

9064 E GARY LN

MESA, AZ 85207-4236

Int Rel

CLAIMANT

Mer Twp Rng Sec  
14 0040N 0090W 008

Quadrant  
NW

District/Field Office  
HASSAYAMPA FO

County  
MARICOPA

*Changed WUP,  
see 2016 WUP*

Act Date	Code	Action	Action Remarks	Receipt Number
09/01/2012	403	LOCATION DATE		
10/09/2012	395	RECORDATION NOTICE RECD	1	2668338
08/19/2015	483	SMALL MINER CERT FILED	2016	
08/19/2015	480	EVID OF ASSMT FILED	2015	3370789
08/21/2014	483	SMALL MINER CERT FILED	2015	
08/21/2014	480	EVID OF ASSMT FILED	2014	3108032
08/21/2013	483	SMALL MINER CERT FILED	2014	
10/09/2012	484	LOCATION YEAR / MAINTENANCE	2013;\$140	2668338
08/21/2013	481	NOTICE OF INTENT TO HOLD	2013	2861022
05/06/2013	669	LAND STATUS CHECKED		
10/09/2012	501	ACCT ADV IN LEAD FILE	AMC417748-AMC417749;	

Line Nr Remarks

ENTERED OCT 02 2012

Amc 417748  
Clear

Form 3830-2  
(October 2013)

UNITED STATES  
DEPARTMENT OF THE INTERIOR  
BUREAU OF LAND MANAGEMENT

365

*[Handwritten signature]*

MAINTENANCE FEE WAIVER CERTIFICATION

FORM APPROVED  
OMB NO. 1004-0114  
Expires: October 31, 2016

SEE INSTRUCTIONS ON PAGE 2

1. This small miner waiver is filed for the assessment year beginning on September 1, 2015 and ending on September 1, 2016.
2. The undersigned and all related parties owned ten or fewer mining claims, mill, or tunnel sites located and maintained on Federal lands in the United States of America on September 1, 2015.
3. The undersigned have performed the assessment work required by law for each mining claim listed prior to filing this waiver and understand that by filing this form, the undersigned must file an affidavit of assessment work with the Bureau of Land Management (BLM) by the December 30th following the filing of this waiver.
4. The undersigned understand that if the assessment work obligation has not yet come due under 30 U.S.C. 28 (for those claims in their first assessment year only), a notice of intent to hold reciting this condition must be recorded by the December 30th following the filing of this waiver.
5. The undersigned understand that mill and tunnel sites may also be listed on this waiver and be waived from payment of the maintenance fee, and that a notice of intent to hold for these sites is required to be filed with the BLM by the December 30th following the filing of this waiver.
6. The undersigned understand and acknowledge that pursuant to 43 U.S.C. 1212 and 18 U.S.C. 1001, the filing or recording of a false, fictitious, or fraudulent document with the BLM may result in a fine of up to \$250,000, a prison term not to exceed five years, or both.
7. The mining claims, mill or tunnel sites for which this waiver from payment of the maintenance fees is requested are:

CLAIM OR SITE NAME	BLM RECORDATION SERIAL NUMBER
1. No Clue # /	AMC417748 ✓
2.	
3.	
4.	
5.	
6.	
7.	
8.	
9.	
10.	

The owner(s) (claimants) of the above mining claims and sites are:

Robert Scott Williams  
(Owner's Name - Please Print)

7916 E Irwin Ave  
(Owner's Mailing Address)

Robert Scott Williams  
(Owner's Signature)

Mesa AZ 85209  
(City) (State) (Zip Code)

OWNER OF CLAIM = RUSSELL WILLIAMS  
(Owner's Name - Please Print)

(Owner's Mailing Address)

(Owner's Signature)

(City) (State) (Zip Code)

(Owner's Name - Please Print)

(Owner's Mailing Address)

Corrected WVR rec'd on OCT 05 2015  
(Owner's Signature)

(City) (State) (Zip Code)

ENTERED SEP 09 2015  
PB  
(Owner's Name - Please Print)

(Owner's Mailing Address)

NW CHECK  
Good PB  
(Owner's Signature)

(City) (State) (Zip Code)

RECEIVED  
BLM AZ STATE OFFICE  
2015 AUG 19 A 10:30  
PHOENIX, ARIZONA

RECEIVED  
BLM AZ STATE OFFICE

2015 AUG 19 A 10: 30

PHOENIX, ARIZONA

PHOENIX, ARIZONA

PHOENIX, ARIZONA



UNITED STATES  
DEPARTMENT OF THE INTERIOR  
BUREAU OF LAND MANAGEMENT

366

*Handwritten signature*

AMC 417749

Clear

MAINTENANCE FEE WAIVER CERTIFICATION

FORM APPROVED  
OMB NO. 1004-0114  
Expires: October 31, 2016

SEE INSTRUCTIONS ON PAGE 2

1. This small miner waiver is filed for the assessment year beginning on September 1, 2015 and ending on September 1, 2016.
2. The undersigned and all related parties owned ten or fewer mining claims, mill, or tunnel sites located and maintained on Federal lands in the United States of America on September 1, 2015.
3. The undersigned have performed the assessment work required by law for each mining claim listed prior to filing this waiver and understand that by filing this form, the undersigned must file an affidavit of assessment work with the Bureau of Land Management (BLM) by the December 30th following the filing of this waiver.
4. The undersigned understand that if the assessment work obligation has not yet come due under 30 U.S.C. 28 (for those claims in their first assessment year only), a notice of intent to hold reciting this condition must be recorded by the December 30th following the filing of this waiver.
5. The undersigned understand that mill and tunnel sites may also be listed on this waiver and be waived from payment of the maintenance fee, and that a notice of intent to hold for these sites is required to be filed with the BLM by the December 30th following the filing of this waiver.
6. The undersigned understand and acknowledge that pursuant to 43 U.S.C. 1212 and 18 U.S.C. 1001, the filing or recording of a false, fictitious, or fraudulent document with the BLM may result in a fine of up to \$250,000, a prison term not to exceed five years, or both.
7. The mining claims, mill or tunnel sites for which this waiver from payment of the maintenance fees is requested are:

CLAIM OR SITE NAME	BLM RECORDATION SERIAL NUMBER
1. No Clue # 2	AMC 417749 ✓
2.	
3.	
4.	
5.	
6.	
7.	
8.	
9.	
10.	

The owner(s) (claimants) of the above mining claims and sites are:

*Russell Williams*  
 (Owner's Name - Please Print)  
 9064 E. Gary Ln.  
 (Owner's Mailing Address)

*Russell Williams*  
 (Owner's Signature)  
 Mesa AZ 85207  
 (City) (State) (Zip Code)

OWNER OF CLAIM = SCOTT WILLIAMS  
 (Owner's Name - Please Print)  
 (Owner's Mailing Address)

(Owner's Signature)  
 (City) (State) (Zip Code)

(Owner's Name - Please Print)  
 Corrected WVR  
 Rec'd on OCT 05 2015  
 (Owner's Mailing Address)

AC 483 / 247  
 ENTERED SEP 09 2015  
 PB  
 9-9-15  
 NW CHECK  
 Wood PB

(Owner's Signature)  
 (City) (State) (Zip Code)

(Owner's Name - Please Print)  
 (Owner's Mailing Address)

(Owner's Signature)  
 (City) (State) (Zip Code)

RECEIVED  
 BLM ARIZONA STATE OFFICE  
 2015 AUG 19 A 10:39  
 PHOENIX, ARIZONA



RECEIVED  
BLM AZ STATE OFFICE

2015 AUG 19 A 10:30

PHOENIX, ARIZONA

When Recorded Return Document to:  
Russell Williams  
9064 E. Gary Ln  
Mesa, AZ 85207-4236

Check here is this is a change of address.

Telephone: 602-809-2959

E-mail address: rfwaz66@yahoo.com

**AFFIDAVIT OF PERFORMANCE OF ANNUAL WORK**

1. State of Arizona, County of Maricopa ss:

2. I (Name) Russell Williams ✓

3. Reside at (Address) 9064 E. Gary Ln

City Mesa County Maricopa

RECEIVED  
 BLM AZ STATE OFFICE  
 2015 AUG 19 A 10:30  
 PHOENIX, ARIZONA  
 BLM  
 Date  
 Stamp

State AZ Zip 85207-4236 being duly sworn, depose and say that I am a citizen of the United States, more than eighteen years of age, and that all of the facts set forth in this affidavit, subject to the provisions and penalties of 18 U.S.C. 1001 pertaining to the filing of false, fictitious, or fraudulent statements with the United States, are true and correct according to the best of my knowledge, information and belief.

4. Owner's name and address (If not shown in Items 1-3 above). \_\_\_\_\_

5. That I am personally acquainted with the mining claim(s). The work and improvements were made by and at the expense of the owner(s) of said claim(s). Said contiguous group of claims, listed on this document, are situated in the

(optional) Mining District; Maricopa County, Arizona.

Line No.	AMC NUMBER	CLAIM/SITE NAME	COUNTY RECORDER DATA (If available)	TWP	RNG	SEC
1	AMC417748 ✓	No Clue #1		4N	9W	7
2						
3						
4						
5						
6						

ENTERED  
 AUG 25 2015  
 BY: RE

**AFFIDAVIT OF PERFORMANCE OF ANNUAL WORK – page 2**

RECEIVED  
BLM AZ STATE OFFICE  
2015 AUG 19 A 10: 30  
PHOENIX, ARIZONA

BLM  
Date  
Stamp

7						
8						
9						
10						

6. That between the dates starting at 12 o'clock noon on September 1, 20 14 and ending at 12 o'clock noon on September 1, 20 15 at least \$ 225 dollars worth of work and improvements were done and performed upon said claim(s) or upon one or more of a contiguous group of claims for the benefit of all, wholly or partly outside of a contiguous group of claims for the benefit of all, not including the location work.

7. That the following persons were employed to perform the work and improvements described herein: \_\_\_\_\_

8. That the work and improvements performed were: \_\_\_\_\_

Metal detecting - Sampling - Picking up trash

9. Dated 6-30-15 Signature: Russell Wie

SUBSCRIBED AND SWORN TO before me, a Notary Public, this 30<sup>th</sup> day of June 20 15

By: Renee Navarro  
Notary Public Renee Navarro

My Commission Expires 1/6/19

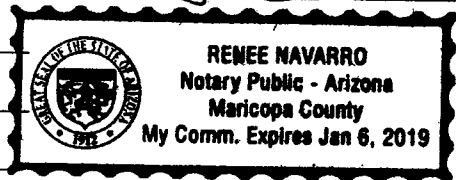

Bureau of Land Management  
Arizona State Office  
[www.blm.gov/az](http://www.blm.gov/az)

No. of Claims: 1 x \$10 = 10  
 Check No.: cc Init. JML  
 Receipt No.: 3370789  
 For BLM Use Only

Form: MCF108  
Revised July 2014  
Page 2 of 2

When Recorded Return Document to:

Scott Williams

9064 E. Gary Ln

Mesa, AZ 85207-4236

Check here is this is a change of address.

Telephone: \_\_\_\_\_

E-mail address: \_\_\_\_\_

**AFFIDAVIT OF PERFORMANCE OF ANNUAL WORK**

1. State of Arizona, County of Maricopa ss:

2. I (Name) Scott Williams

3. Reside at (Address) 9064 E. Gary Ln

City Mesa County Maricopa

RECEIVED  
 BLM AZ STATE OFFICE  
 2015 AUG 19 A 10:30  
 PHOENIX, ARIZONA  
 BLM  
 Date  
 Stamp

State AZ Zip 85207-4236 being duly sworn, depose and say that I am a citizen of the United States, more than eighteen years of age, and that all of the facts set forth in this affidavit, subject to the provisions and penalties of 18 U.S.C. 1001 pertaining to the filing of false, fictitious, or fraudulent statements with the United States, are true and correct according to the best of my knowledge, information and belief.

4. Owner's name and address (If not shown in Items 1-3 above). \_\_\_\_\_

5. That I am personally acquainted with the mining claim(s). The work and improvements were made by and at the expense of the owner(s) of said claim(s). Said contiguous group of claims, listed on this document, are situated in the

\_\_\_\_\_ (optional) Mining District; Maricopa County, Arizona.

Line No.	AMC NUMBER	CLAIM/SITE NAME	COUNTY RECORDER DATA (If available)	TWP	RNG	SEC
1	AMC417749	No Clue #2		4N	9W	8
2						
3						
4						
5						
6						

ENTERED  
 AUG 25 2015  
 BY: RS



AFFIDAVIT OF PERFORMANCE OF ANNUAL WORK – page 2

RECEIVED  
BLM AZ STATE OFFICE

2015 AUG 19 A 10:30  
PHOENIX, ARIZONA

BLM  
Date  
Stamp

7						
8						
9						
10						

6. That between the dates starting at 12 o'clock noon on September 1, 20 14 and ending at 12 o'clock noon on September 1, 20 15 at least \$ 200 dollars worth of work and improvements were done and performed upon said claim(s) or upon one or more of a contiguous group of claims for the benefit of all, wholly or partly outside of a contiguous group of claims for the benefit of all, not including the location work.

7. That the following persons were employed to perform the work and improvements described herein: \_\_\_\_\_

8. That the work and improvements performed were: Filling Holes in Road, picking up Trash - Metal Detecting

9. Dated: 6-30-15 Signature: Robert Scott Williams

SUBSCRIBED AND SWORN TO before me, a Notary Public, this 30 day of June 20 15

By: Renee Navarro  
Notary Public [Signature]  
My Commission Expires 1/6/19

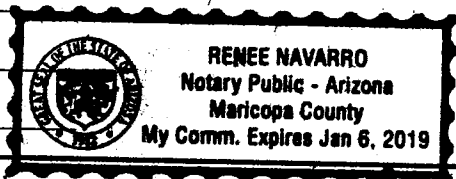

No. of Claims: 1 x \$10 = 10  
 Check No.: CE Init. [Signature]  
 Receipt No.: 9370789  
 For BLM Use Only

Bureau of Land Management  
Arizona State Office  
[www.blm.gov/az](http://www.blm.gov/az)

**United States Department of the Interior**  
**Bureau of Land Management**  
 LANDS/RECREATION & PLANNING  
 ONE N CENTRAL AVE  
 PHOENIX, AZ 85004 -2203  
 Phone: 602-417-9200

Receipt

No: 3370789

<b>Transaction #:</b> 3468951	<b>ENTERED INTO COMPUTER</b>
<b>Date of Transaction:</b> 08/19/2015	
CUSTOMER:	
RUSSELL WILLIAMS 9064 E GARY LN MESA, AZ 85207-4236 US	

LINE #	QTY	DESCRIPTION	REMARKS	UNIT PRICE	TOTAL
1	1.00	LOCATABLE MINERALS / MINING CLAIMS- NOT NEW-UNADJUD, ONE AUTH NO. ONLY / MINING CLAIM MONEY RECEIVED CASES: AMC417748/\$20.00	POL 2015/2 WAV	- n/a -	20.00
<b>TOTAL:</b>					<b>\$20.00</b>

PAYMENT INFORMATION			
NOTE: Items will appear on credit card statement as "Bureau of Land Mgmt CO".			
1	AMOUNT:	20.00	POSTMARKED: N/A
	TYPE:	CREDIT CARD	RECEIVED: 08/19/2015
	NAME:	WILLIAMS, RUSSELL 9064 E GARY LN MESA AZ 85207-4236 US	
	CARD NO:	XXXXXXXXXXXX4717	AUTH CODE: 00680G
	NAME ON CARD:	RUSSELL F WILLIAMS	
	EXPIRES:	08/2016	
	SIGNATURE:		

REMARKS

This receipt was generated by the automated BLM Collections and Billing System and is a paper representation of a portion of the official electronic record contained therein.

UNITED STATES DEPARTMENT OF THE INTERIOR  
BUREAU OF LAND MANAGEMENT

MC NATIONWIDE CLAIMANT LISTING  
September 09, 2015

Cust	AZ	NM	OR	National Total
	CLAIMANT	CLAIMANT	CLAIMANT	
WILLIAMS RUSSELL 9064 E GARY LN MESA, AZ 85207-4236	2			2
WILLIAMS SCOTT 34890 SE SURFACE RD ESTACADA, OR 97023-9444			3	3
WILLIAMS SCOTT 9064 E GARY LN MESA, AZ 85207-4236	1			1
WILLIAMS SCOTT D 1302 N DATE ST TRUTH OR CONSEQUENCES, NM 87901-1773		1		1
WILLIAMS SCOTT W 769 SARAH PARK CIR EAGLE POINT, OR 97524-9755			2	2

Run Time: 11:00 AM

Department of the Interior  
Bureau of Land Management  
Public Land Statistics

Run Date: 09/09/2015

Nationwide Claimant Listing  
(Mining Claim Only)

Selection Criteria

System Id = MC

Cust Nm Begins With WILLIAMS ROBERT SCOTT, WILLIAMS RUSSELL, WILLIAMS SCOTT

Loc Dt Between

Address Begins With

City Begins With

State Begins With

Case Disp = A

Total Rows Returned: 9



# Mass Add/Delete/Update Action Data

Starting Serial Number Ending Serial Number

417748

417749

	Action Data:
Action Code:	247 <input type="button" value="Lookup"/>
Action Remark:	2016 WVR CORRECTIO Action 484 Amounts: <input type="radio"/> \$ <input type="radio"/> \$
Action Date:	08/19/2015
Receipt Nr:	

*MUST CORRECT CLAIM OWNER'S Name on both Waivers. PB*

[AMC417748] -  - 247 - 2016 WVR CORRECTION  
[AMC417749] -  - 247 - 2016 WVR CORRECTION

*10/5/2015  
AC 247 removed.  
PB*

=====  
Total Amount Processed : \$0.00

	Update Action Data:
Action Code:	<input type="button" value="Lookup"/>
Action Remark:	
Action Date:	
Receipt Nr:	

10934a

9-9-15 602-509-2959

= spoke to Scott W.

= will send in corrected waivers,

**DEPARTMENT OF THE INTERIOR  
BUREAU OF LAND MANAGEMENT  
MINING CLAIMS**

Run Date/Time: 09/09/2015 10:44 AM

**(LIVE) Serial Register Page**

Page 1 of 1

**01 10-21-1976;090STAT0090;43USC1744**  
**Case Type 384201: PLACER CLAIM**  
**Claim Name: NO CLUE #1**  
**Commodity :**  
**Case Disposition: ACTIVE**  
**Required Maintenance Fee: \$155.00**

**Total Acres**  
**20.000**

**Serial Number**  
**AMC417748**  
**Lead File Number**  
**AMC417748**

Name & Address	Int Rel
WILLIAMS RUSSELL 9064 E GARY LN MESA, AZ 85207-4236	CLAIMANT

Mer Twp	Rng	Sec	Quadrant	District/Field Office	County
14	0040N	0090W	007 NE	HASSAYAMPA FO	MARICOPA

Act Date	Code	Action	Action Remarks	Receipt Number
09/01/2012	403	LOCATION DATE		
10/09/2012	395	RECORDATION NOTICE RECD	1	2668338
08/19/2015	483	SMALL MINER CERT FILED	2016	
08/19/2015	480	EVID OF ASSMT FILED	2015	3370789
08/21/2014	483	SMALL MINER CERT FILED	2015	
08/21/2014	480	EVID OF ASSMT FILED	2014	3108032
08/21/2013	483	SMALL MINER CERT FILED	2014	
10/09/2012	484	LOCATION YEAR / MAINTENANCE	2013;\$140	2668338
08/21/2013	481	NOTICE OF INTENT TO HOLD	2013	2861022
08/19/2015	247	FUTURE ACTION SUSPENSE	2016 WVR CORRECTION	
05/06/2013	669	LAND STATUS CHECKED		
10/09/2012	501	ACCT ADV IN LEAD FILE	AMC417748-AMC417749;	

Line Nr Remarks

**DEPARTMENT OF THE INTERIOR  
BUREAU OF LAND MANAGEMENT  
MINING CLAIMS**

**(LIVE) Serial Register Page**

Run Date/Time: 09/09/2015 08:04 AM

Page 1 of 1

01 10-21-1976;090STAT0090;43USC1744  
Case Type 384201: PLACER CLAIM  
Claim Name: NO CLUE #1  
Commodity :  
Case Disposition: ACTIVE  
Required Maintenance Fee: \$155.00

Total Acres  
20.000

Serial Number  
AMC417748  
Lead File Number  
AMC417748

Name & Address

Int Rel

WILLIAMS RUSSELL 9064 E GARY LN MESA, AZ 85207-4236 CLAIMANT

Mer Twp	Rng	Sec	Quadrant	District/Field Office	County	
14	0040N	0090W	007	NE	HASSAYAMPA FO	MARICOPA

Act Date	Code	Action	Action Remarks	Receipt Number
09/01/2012	403	LOCATION DATE		
10/09/2012	395	RECORDATION NOTICE RECD	1	2668338
08/19/2015	480	EVID OF ASSMT FILED	2015	3370789
08/21/2014	483	SMALL MINER CERT FILED	2015	
08/21/2014	480	EVID OF ASSMT FILED	2014	3108032
08/21/2013	483	SMALL MINER CERT FILED	2014	
10/09/2012	484	LOCATION YEAR / MAINTENANCE	2013;\$140	2668338
08/21/2013	481	NOTICE OF INTENT TO HOLD	2013	2861022
05/06/2013	669	LAND STATUS CHECKED		
10/09/2012	501	ACCT ADV IN LEAD FILE	AMC417748-AMC417749;	

Line Nr Remarks



**DEPARTMENT OF THE INTERIOR  
BUREAU OF LAND MANAGEMENT  
MINING CLAIMS**

**(LIVE) Serial Register Page**

Run Date/Time: 09/09/2015 10:44 AM

Page 1 of 1

**01 10-21-1976;090STAT0090;43USC1744**  
**Case Type 384201: PLACER CLAIM**  
**Claim Name: NO CLUE #2**  
**Commodity :**  
**Case Disposition: ACTIVE**  
**Required Maintenance Fee: \$155.00**

**Total Acres**  
**20.000**

**Serial Number**  
**AMC417749**  
**Lead File Number**  
**AMC417748**

Name & Address	Int Rel
WILLIAMS SCOTT 9064 E GARY LN MESA, AZ 85207-4236	CLAIMANT

Mer Twp	Rng	Sec	Quadrant	District/Field Office	County
14	0040N	0090W	008 NW	HASSAYAMPA FO	MARICOPA

Act Date	Code	Action	Action Remarks	Receipt Number
09/01/2012	403	LOCATION DATE		
10/09/2012	395	RECORDATION NOTICE RECD	1	2668338
08/19/2015	483	SMALL MINER CERT FILED	2016	
08/19/2015	480	EVID OF ASSMT FILED	2015	3370789
08/21/2014	483	SMALL MINER CERT FILED	2015	
08/21/2014	480	EVID OF ASSMT FILED	2014	3108032
08/21/2013	483	SMALL MINER CERT FILED	2014	
10/09/2012	484	LOCATION YEAR / MAINTENANCE 2013;\$140		2668338
08/21/2013	481	NOTICE OF INTENT TO HOLD	2013	2861022
08/19/2015	247	FUTURE ACTION SUSPENSE	2016 WVR CORRECTION	
05/06/2013	669	LAND STATUS CHECKED		
10/09/2012	501	ACCT ADV IN LEAD FILE	AMC417748-AMC417749;	

Line Nr Remarks

**DEPARTMENT OF THE INTERIOR  
BUREAU OF LAND MANAGEMENT  
MINING CLAIMS**

**(LIVE) Serial Register Page**

Run Date/Time: 09/09/2015 08:05 AM

Page 1 of 1

01 10-21-1976;090STAT0090;43USC1744  
Case Type 384201: PLACER CLAIM  
Claim Name: **NO CLUE #2**  
Commodity :  
Case Disposition: ACTIVE  
Required Maintenance Fee: \$155.00

Total Acres  
20.000

Serial Number  
AMC417749  
Lead File Number  
AMC417748

Name & Address	Int Rel
WILLIAMS SCOTT 9064 E GARY LN MESA, AZ 85207-4236	CLAIMANT

Mer Twp Rng Sec	Quadrant	District/Field Office	County
14 0040N 0090W 008	NW	HASSAYAMPA FO	MARICOPA

Act Date	Code	Action	Action Remarks	Receipt Number
09/01/2012	403	LOCATION DATE		
10/09/2012	395	RECORDATION NOTICE RECD	1	2668338
08/19/2015	480	EVID OF ASSMT FILED	2015	3370789
08/21/2014	483	SMALL MINER CERT FILED	2015	
08/21/2014	480	EVID OF ASSMT FILED	2014	3108032
08/21/2013	483	SMALL MINER CERT FILED	2014	
10/09/2012	484	LOCATION YEAR / MAINTENANCE	2013;\$140	2668338
08/21/2013	481	NOTICE OF INTENT TO HOLD	2013	2861022
05/06/2013	669	LAND STATUS CHECKED		
10/09/2012	501	ACCT ADV IN LEAD FILE	AMC417748-AMC417749;	

Line Nr Remarks

**MAINTENANCE FEE WAIVER CERTIFICATION**

FORM APPROVED  
OMB NO. 1004-0114  
Expires: October 31, 2016

SEE INSTRUCTIONS ON PAGE 2

1. This small miner waiver is filed for the assessment year beginning on September 1, 2014 and ending on September 1, 2015.
2. The undersigned and all related parties owned ten or fewer mining claims, mill, or tunnel sites located and maintained on Federal lands in the United States of America on September 1, 2014.
3. The undersigned have performed the assessment work required by law for each mining claim listed prior to filing this waiver and understand that by filing this form, the undersigned must file an affidavit of assessment work with the Bureau of Land Management (BLM) by the December 30th following the filing of this waiver.
4. The undersigned understand that if the assessment work obligation has not yet come due under 30 U.S.C. 28 (for those claims in their first assessment year only), a notice of intent to hold reciting this condition must be recorded by the December 30th following the filing of this waiver.
5. The undersigned understand that mill and tunnel sites may also be listed on this waiver and be waived from payment of the maintenance fee, and that a notice of intent to hold for these sites is required to be filed with the BLM by the December 30th following the filing of this waiver.
6. The undersigned understand and acknowledge that pursuant to 43 U.S.C. 1212 and 18 U.S.C. 1001, the filing or recording of a false, fictitious, or fraudulent document with the BLM may result in a fine of up to \$250,000, a prison term not to exceed five years, or both.
7. The mining claims, mill or tunnel sites for which this waiver from payment of the maintenance fees is requested are:

CLAIM OR SITE NAME	BLM RECORDATION SERIAL NUMBER
1. No Clue #1	✓ AMC417748
2.	
3.	
4.	
5.	
6.	
7.	
8.	
9.	
10.	

The owner(s) (claimants) of the above mining claims and sites are:

Russell Williams  
(Owner's Name - Please Print)  
9064 e. Gary Ln  
(Owner's Mailing Address)

Russell Williams  
(Owner's Signature)  
Mesa AZ 85207  
(City) (State) (Zip Code)

\_\_\_\_\_  
(Owner's Name - Please Print)  
\_\_\_\_\_  
(Owner's Mailing Address)

\_\_\_\_\_  
(Owner's Signature)  
\_\_\_\_\_  
(City) (State) (Zip Code)

\_\_\_\_\_  
(Owner's Name - Please Print)  
\_\_\_\_\_  
(Owner's Mailing Address)

\_\_\_\_\_  
(Owner's Signature)  
\_\_\_\_\_  
(City) (State) (Zip Code)

\_\_\_\_\_  
(Owner's Name - Please Print)  
\_\_\_\_\_  
(Owner's Mailing Address)

\_\_\_\_\_  
(Owner's Signature)  
\_\_\_\_\_  
(City) (State) (Zip Code)

(Continued on page 2)

**ENTERED**  
**SEP 11 2014**  
BY: pm

PHOENIX, ARIZONA  
2014 AUG 21 PM 12:33  
RECEIVED  
BLM AZ STATE OFFICE

nw  
9/22/2014  
pm



**AFFIDAVIT OF ANNUAL ASSESSMENT WORK**

417748

**WHEN RECORDED, MAIL DOCUMENT TO:**

**NAME:** Russel Williams

**ADDRESS:** 9064 E Gary Ln.

**CITY, STATE, ZIP:** Mesa, AZ 85207 - 4236

**FOR COUNTY RECORDER'S USE**

No. of Claims 1

x \$10/claim

Total due BLM \$ 10.00

**TO ALL WHOM IT MAY CONCERN:**

- The undersigned certifies that at least \$100 per claim was expended for development, labor and improvements, or equivalent value added, as the annual assessment work for the assessment year ending September 1, 2014 for the following contiguous unpatented mining claim(s), located in the County of Maricopa, in the State of AZ.

BLM Serial No.	Name of Claim	Tp Rg Sec Mer				County Recordation Book and Page No.	Date
		Example: 13N 5E 14 MDM					
AMC417748	NO CLUE #1	4N	9W	7	14		

RECEIVED  
BLM AZ STATE OFFICE  
2014 AUG 21 P 2:33  
PHOENIX, ARIZONA

INTEREST  
AUG 25 2014  
BY: Ran

# 3108032



2. Type of labor and improvements (specify what was done and give the total value for that labor and improvement to show at least \$100 for each claim). If a geological, geochemical, or geophysical survey was performed, as per 30 U.S.C. 28-1, reference the title of the report of survey, give cost and date of the survey and report, and indicate it was filed with the County Recorder:

Description of Work Performed	Value of Work Performed	Date Work Was Performed
Metal detecting & Sampling	\$200	Feb-1-2014

3. Name and mailing address of each person who performed the labor and improvements:

<p>Name (please print)  <u>Russell Williams</u></p> <p>_____</p> <p>_____</p> <p>_____</p>	<p>Current Mailing Address (please print)  <u>9064 E. Gary Ln. Mesa, AZ 85207</u></p> <p>_____</p> <p>_____</p> <p>_____</p>
--	--

4. Name and mailing address of each person who holds and claims the subject mining claim(s) for the valuable minerals contained therein. Be sure to indicate if there is a change of address:

<p>Name (please print)  <u>Russell Williams</u></p> <p>_____</p> <p>_____</p> <p>_____</p> <p>_____</p> <p>_____</p>	<p>Current Mailing Address (please print)  <u>9064 E Gary Ln Mesa, AZ 85207-4236</u></p> <p>_____</p> <p>_____</p> <p>_____</p> <p>_____</p> <p>_____</p>
--	---

RECEIVED  
 IN AZ STATE OFFICE  
 2014 AUG 21 P 12:33  
 PHOENIX, ARIZONA

5. The undersigned testifies that on the date of 2-1-14, 2014, all monuments required by law were erected upon the subject claim(s), and all notices required by law were posted on the subject claim(s) or copies thereof were in place, and at said date, each corner monument bore or contained

~~markings sufficient to appropriately designate the corner of the claim to which it pertains and the name of the claim(s).~~

I hereby certify under penalty of perjury under the laws of the State of AZ that the foregoing statements are true and correct:

Renee Will

Date: 8-21-14

(Signature of person responsible for above statement)

Title 18 U.S.C. 1001 and 43 U.S.C. 1212 make it a crime for any person knowingly and willfully to make to any department or agency of the United States any false, fictitious or fraudulent statements or representations as to any matter within its jurisdiction.

### Notary Block

SUBSCRIBED AND SWORN TO before me, this 21 day of August 20 14

By: Renee Will  
(Signature of Affiant)

Title: Notary

My Commission Expires: June 25, 2018

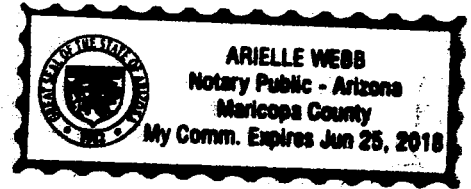

### INSTRUCTIONS

1. This is an optional form that may be used to satisfy the requirements for the Bureau of Land Management (BLM) under the provisions of 43 U.S.C. §1744 and 30 U.S.C. §28-28d and the regulations thereunder (43 CFR part 3835). Since local and State laws may vary, you should contact your local and State agencies where the claims are located to ensure all applicable laws and requirements are satisfied.
2. The claimant(s) must fill in the date in paragraph 1 for the applicable assessment year and the county and state where the claims are located.
3. All claim names, BLM serial numbers, legal descriptions, and original county recording information must be listed for the claims pertaining to this assessment notice.
4. The claimant(s) must complete paragraph 2 listing all labor or improvements which was performed on and did benefit the subject mining claims. The value and date of the labor or improvements must also be listed. The total amount of labor or improvements can be listed, but the total expenditure must equal at least \$100 for each claim.
5. The names and current mailing addresses of the person(s) performing the labor shall be listed in paragraph 3.
6. The name and current mailing address of each owner (claimant) of the claims shall be listed in paragraph 4. The mailing address shall be the owner's address and not the address of an agent or anyone representing the claimant. Be sure to note if there has been a change of address.
7. Paragraph 5 shall be completed to show the date it was verified that all monuments required by law were properly erected, all notices were posted, and that corners were appropriately designated for all claims listed.
8. An exact legible reproduction or duplicate (other than microfilm or other electronic media) of this affidavit or another type of affidavit of assessment work that you file or will file in the county where each claim is located, must be filed with the BLM on or before December 30 of the calendar year in which the assessment year ends. For mill or tunnel sites, a separate notice of intent to hold must be filed with the BLM on or before December 30. Requirements for filing a notice of intent to hold can be found at 43 CFR 3835.33.
9. A processing fee of \$10 for each claim listed must be remitted to the BLM along with this or any other affidavit of assessment work.

375

*Handwritten initials/signature*

MAINTENANCE FEE WAIVER CERTIFICATION

FORM APPROVED  
OMB NO. 1004-0114  
Expires: October 31, 2016

SEE INSTRUCTIONS ON PAGE 2

1. This small miner waiver is filed for the assessment year beginning on September 1, 2014 and ending on September 1, 2015.
2. The undersigned and all related parties owned ten or fewer mining claims, mill, or tunnel sites located and maintained on Federal lands in the United States of America on September 1, 2014.
3. The undersigned have performed the assessment work required by law for each mining claim listed prior to filing this waiver and understand that by filing this form, the undersigned must file an affidavit of assessment work with the Bureau of Land Management (BLM) by the December 30th following the filing of this waiver.
4. The undersigned understand that if the assessment work obligation has not yet come due under 30 U.S.C. 28 (for those claims in their first assessment year only), a notice of intent to hold reciting this condition must be recorded by the December 30th following the filing of this waiver.
5. The undersigned understand that mill and tunnel sites may also be listed on this waiver and be waived from payment of the maintenance fee, and that a notice of intent to hold for these sites is required to be filed with the BLM by the December 30th following the filing of this waiver.
6. The undersigned understand and acknowledge that pursuant to 43 U.S.C. 1212 and 18 U.S.C. 1001, the filing or recording of a false, fictitious, or fraudulent document with the BLM may result in a fine of up to \$250,000, a prison term not to exceed five years, or both.
7. The mining claims, mill or tunnel sites for which this waiver from payment of the maintenance fees is requested are:

CLAIM OR SITE NAME	BLM RECORDATION SERIAL NUMBER
1. NO CLUE #2	AMC417749
2.	
3.	
4.	
5.	
6.	
7.	
8.	
9.	
10.	

The owner(s) (claimants) of the above mining claims and sites are:

<u>Scott Williams</u> (Owner's Name - Please Print)	<u>Scott Williams</u> (Owner's Signature)
<u>9064 E. gary Ln</u> (Owner's Mailing Address)	<u>Mesa</u> (City) <u>AZ</u> (State) <u>85207</u> (Zip Code)
-----	
_____ (Owner's Name - Please Print)	_____ (Owner's Signature)
_____ (Owner's Mailing Address)	_____ (City)      _____ (State)      _____ (Zip Code)
-----	
_____ (Owner's Name - Please Print)	_____ (Owner's Signature)
_____ (Owner's Mailing Address)	_____ (City)      _____ (State)      _____ (Zip Code)
-----	
_____ (Owner's Name - Please Print)	_____ (Owner's Signature)
_____ (Owner's Mailing Address)	_____ (City)      _____ (State)      _____ (Zip Code)

RECEIVED  
BLM AZ STATE OFFICE  
2014 AUG 21 P 12:33  
PHOENIX, ARIZONA

ENTERED  
SEP 11 2014  
BY: fm

(Continued on page 2)

NW  
9/22/2014  
fm

**AFFIDAVIT OF ANNUAL ASSESSMENT WORK**

417748

**WHEN RECORDED, MAIL DOCUMENT TO:**

**NAME:** Russel Williams

**ADDRESS:** 9064 E Gary Ln.

**CITY, STATE, ZIP:** Mesa, AZ 85207-4236

**FOR COUNTY RECORDER'S USE**

No. of Claims 1

x \$10/claim

Total due BLM \$ 10.00

**TO ALL WHOM IT MAY CONCERN:**

- The undersigned certifies that at least \$100 per claim was expended for development, labor and improvements, or equivalent value added, as the annual assessment work for the assessment year ending September 1, 2014 for the following contiguous unpatented mining claim(s), located in the County of Maricopa, in the State of AZ.

BLM Serial No.	Name of Claim	Tp Rg Sec Mer				County Recordation Book and Page No.	Date
		Example: 13N 5E 14 MDM					
AMC417748 417749	NO CLUE #2	4N	9W	7	14		

RECEIVED  
 MARICOPA STATE OFFICE  
 PHOENIX, ARIZONA  
 2014 AUG 21 12:33

ENTERED  
 AUG 25 2014  
 BY: RAM



2. Type of labor and improvements (specify what was done and give the total value for that labor and improvement to show at least \$100 for each claim). If a geological, geochemical, or geophysical survey was performed, as per 30 U.S.C. 28-1, reference the title of the report of survey, give cost and date of the survey and report, and indicate it was filed with the County Recorder:

Description of Work Performed	Value of Work Performed	Date Work Was Performed
Dry Washing & Sampling	\$200 <sup>00</sup>	Feb-11 2014

3. Name and mailing address of each person who performed the labor and improvements:

Name (please print)  
SCOTT WILLIAMS

Current Mailing Address (please print) 85207-4236  
9064 E GARY LN MESA, AZ

4. Name and mailing address of each person who holds and claims the subject mining claim(s) for the valuable minerals contained therein. Be sure to indicate if there is a change of address:

Name (please print)  
Scott Williams

Current Mailing Address (please print)  
9064 E Gary Ln Mesa, AZ 85207-4236

RECEIVED  
 M AZ STATE OFFICE  
 2014 AUG 21 P 12:33  
 PHOENIX, ARIZONA

5. The undersigned testifies that on the date of 2/11, 2014, all monuments required by law were erected upon the subject claim(s), and all notices required by law were posted on the subject claim(s) or copies thereof were in place, and at said date, each corner monument bore or contained

~~markings sufficient to appropriately designate the corner of the claim to which it pertains and the name of the claim(s).~~

I hereby certify under penalty of perjury under the laws of the State of AZ that the foregoing statements are true and correct:

Russell Wilson

(Signature of person responsible for above statement)

Date: 8-21-14

Title 18 U.S.C. 1001 and 43 U.S.C. 1212 make it a crime for any person knowingly and willfully to make to any department or agency of the United States any false, fictitious or fraudulent statements or representations as to any matter within its jurisdiction.

### Notary Block

SUBSCRIBED AND SWORN TO before me, this 21 day of August 20 14

By: Ariel Webb  
(Signature of Affiant)

Title: Notary

My Commission Expires: June 25, 2018



### INSTRUCTIONS

1. This is an optional form that may be used to satisfy the requirements for the Bureau of Land Management (BLM) under the provisions of 43 U.S.C. §1744 and 30 U.S.C. §28-28d and the regulations thereunder (43 CFR part 3835). Since local and State laws may vary, you should contact your local and State agencies where the claims are located to ensure all applicable laws and requirements are satisfied.
2. The claimant(s) must fill in the date in paragraph 1 for the applicable assessment year and the county and state where the claims are located.
3. All claim names, BLM serial numbers, legal descriptions, and original county recording information must be listed for the claims pertaining to this assessment notice.
4. The claimant(s) must complete paragraph 2 listing all labor or improvements which was performed on or did benefit the subject mining claims. The value and date of the labor or improvements must also be listed. The total amount of labor or improvements can be listed, but the total expenditure must equal at least \$100 for each claim.
5. The names and current mailing addresses of the person(s) performing the labor shall be listed in paragraph 4.
6. The name and current mailing address of each owner (claimant) of the claims shall be listed in paragraph 4. The mailing address shall be the owner's address and not the address of an agent or anyone representing the claimant. Be sure to note if there has been a change of address.
7. Paragraph 5 shall be completed to show the date it was verified that all monuments required by law were properly erected, all notices were posted, and that corners were appropriately designated for all claims listed.
8. An exact legible reproduction or duplicate (other than microfilm or other electronic media) of this affidavit or another type of affidavit of assessment work that you file or will file in the county where each claim is located, must be filed with the BLM on or before December 30 of the calendar year in which the assessment year ends. For mill or tunnel sites, a separate notice of intent to hold must be filed with the BLM on or before December 30. Requirements for filing a notice of intent to hold can be found at 43 CFR 3835.33.
9. A processing fee of \$10 for each claim listed must be remitted to the BLM along with this or any other affidavit of assessment work.

**United States Department of the Interior**  
**Bureau of Land Management**  
 LANDS/RECREATION & PLANNING  
 ONE N CENTRAL AVE  
 PHOENIX, AZ 85004 -2203  
 Phone: 602-417-9200

ENTERED  
 AUG 25 2014  
 BY: *R. Williams*

Receipt

No: 3108032

<b>Transaction #:</b> 3199698	
<b>Date of Transaction:</b> 08/21/2014	
CUSTOMER:	
RUSSELL WILLIAMS 9064 E GARY LN MESA, AZ 85207-4236 US	

LINE #	QTY	DESCRIPTION	REMARKS	UNIT PRICE	TOTAL
1	1.00	LOCATABLE MINERALS / MINING CLAIMS- NOT NEW-UNADJUD, ONE AUTH NO. ONLY / MINING CLAIM MONEY RECEIVED <b>CASES: AMC417748/\$20.00</b>	POL 2014/2 WAV	- n/a -	20.00
<b>TOTAL:</b>					<b>\$20.00</b>

PAYMENT INFORMATION			
NOTE: Items will appear on credit card statement as "Bureau of Land Mgmt CO".			
1	AMOUNT:	20.00	POSTMARKED: N/A
	TYPE:	CREDIT CARD	RECEIVED: 08/21/2014
	NAME:	WILLIAMS, RUSSELL 9064 E GARY LN MESA AZ 85207-4236 US	
	CARD NO:	XXXXXXXXXXXX4717	AUTH CODE: 07618G
	NAME ON CARD:	RUSSEL F WILLIAMS0816	
	EXPIRES:	08/2016	
	SIGNATURE:		

REMARKS

This receipt was generated by the automated BLM Collections and Billing System and is a paper representation of a portion of the official electronic record contained therein.

417748

UNITED STATES  
DEPARTMENT OF THE INTERIOR  
BUREAU OF LAND MANAGEMENT

MAINTENANCE FEE WAIVER CERTIFICATION

*[Handwritten signature]*  
392

FORM APPROVED  
OMB NO. 1004-0114  
Expires: August 31, 2013

SEE INSTRUCTIONS ON PAGE 2

1. This small miner waiver is filed for the assessment year beginning on September 1, 2013 and ending on September 1, 2014.
2. The undersigned and all related parties owned ten or fewer mining claims, mill, or tunnel sites located and maintained on Federal lands in the United States of America on September 1, 2013.
3. The undersigned have performed the assessment work required by law for each mining claim listed prior to filing this waiver and understand that by filing this form, an affidavit of assessment work must be recorded by the December 30th following the filing of this waiver.
4. The undersigned understand that if the assessment work obligation has not yet come due under 30 U.S.C. 28 (for those claims in their first assessment year only), a notice of intent to hold reciting this condition must be recorded by the December 30th following the filing of this waiver.
5. The undersigned understand that mill and tunnel sites may also be listed upon this waiver and be waived from payment of the maintenance fee, and that a notice of intent to hold for these sites is required to be recorded by the December 30th immediately following the filing of this waiver.
6. The undersigned understand and acknowledge that pursuant to 43 U.S.C. 1212 and 18 U.S.C. 1001, the filing or recording of a false, fictitious, or fraudulent document with the Bureau of Land Management may result in a fine of up to \$250,000, a prison term not to exceed five years, or both.
7. The mining claims, mill or tunnel sites for which this waiver from payment of the maintenance fees is requested are:

CLAIM OR SITE NAME	BLM RECORDATION SERIAL NUMBER
1. NO CLUE #1	AMC417748
2.	
3.	
4.	
5.	
6.	
7.	
8.	
9.	
10.	

The owner(s) (claimants) of the above mining claims and sites are:

Russell Williams  
(Owner's Name - Please Print)

9064 E. Gary Ln.  
(Street or P.O. Box)

Mesa      AZ      85207  
(City)      (State)      (Zip Code)

Russell Williams  
(Owner's Signature)

\_\_\_\_\_  
(Owner's Name - Please Print)

\_\_\_\_\_  
(Street or P.O. Box)

\_\_\_\_\_  
(City)      (State)      (Zip Code)

\_\_\_\_\_  
(Owner's Signature)

\_\_\_\_\_  
(Owner's Name - Please Print)

\_\_\_\_\_  
(Street or P.O. Box)

\_\_\_\_\_  
(City)      (State)      (Zip Code)

\_\_\_\_\_  
(Owner's Signature)

**ENTERED**  
**SEP 17 2013**  
BY: TS

RECEIVED  
 BLM AZ STATE OFFICE  
 PHOENIX, ARIZONA  
 2013 AUG 21 A 11:43



RECEIVED  
BLM AZ STATE OFFICE

2013 AUG 21 A 11:43

PHOENIX, ARIZONA

2013 AUG 21 11:43 AM  
BLM AZ STATE OFFICE

PHOENIX, ARIZONA

2013 AUG 21 11:43 AM

BLM AZ STATE OFFICE

UNITED STATES  
DEPARTMENT OF THE INTERIOR  
BUREAU OF LAND MANAGEMENT

MAINTENANCE FEE WAIVER CERTIFICATION

*Handwritten initials*  
**393**

FORM APPROVED  
OMB NO. 1004-0114  
Expires: August 31, 2013

SEE INSTRUCTIONS ON PAGE 2

1. This small miner waiver is filed for the assessment year beginning on September 1, 2013 and ending on September 1, 2014.
2. The undersigned and all related parties owned ten or fewer mining claims, mill, or tunnel sites located and maintained on Federal lands in the United States of America on September 1, 2013.
3. The undersigned have performed the assessment work required by law for each mining claim listed prior to filing this waiver and understand that by filing this form, an affidavit of assessment work must be recorded by the December 30th following the filing of this waiver.
4. The undersigned understand that if the assessment work obligation has not yet come due under 30 U.S.C. 28 (for those claims in their first assessment year only), a notice of intent to hold reciting this condition must be recorded by the December 30th following the filing of this waiver.
5. The undersigned understand that mill and tunnel sites may also be listed upon this waiver and be waived from payment of the maintenance fee, and that a notice of intent to hold for these sites is required to be recorded by the December 30th immediately following the filing of this waiver.
6. The undersigned understand and acknowledge that pursuant to 43 U.S.C. 1212 and 18 U.S.C. 1001, the filing or recording of a false, fictitious, or fraudulent document with the Bureau of Land Management may result in a fine of up to \$250,000, a prison term not to exceed five years, or both.
7. The mining claims, mill or tunnel sites for which this waiver from payment of the maintenance fees is requested are:

CLAIM OR SITE NAME	BLM RECORDATION SERIAL NUMBER
1. NO CLUE #2	✓ AMC417749
2.	
3.	
4.	
5.	
6.	
7.	
8.	
9.	
10.	

The owner(s) (claimants) of the above mining claims and sites are:

SCOTT WILLIAMS  
(Owner's Name - Please Print)

Scott Williams  
(Owner's Signature)

9064 E. GARY Ln.  
(Street or P.O. Box)

Mesa AZ 85207  
(City) (State) (Zip Code)

(Owner's Name - Please Print)

(Owner's Signature)

(Street or P.O. Box)

(City) (State) (Zip Code)

(Owner's Name - Please Print)

(Owner's Signature)

(Street or P.O. Box)

(City) (State) (Zip Code)

PHOENIX, ARIZONA  
RECEIVED  
BLM AZ STATE OFFICE  
AUG 27 11:43

RECEIVED  
BLM AZ STATE OFFICE

2013 AUG 21 A 11:43

PHOENIX, ARIZONA

EMILY J. ...  
2013 AUG 21 11:43

**NOTICE OF INTENTION TO HOLD MINING CLAIMS/SITES**

When Recorded Return Document to:

Russell Williams  
 \_\_\_\_\_  
 9064 E Gary Lane  
 \_\_\_\_\_  
 Mesa , AZ 85207-4236  
 \_\_\_\_\_

RECEIVED  
 BLM AZ STATE OFFICE  
 PHOENIX, ARIZONA  
 2013 AUG 21 A 11:42  
 BLM  
 Date  
 Stamp

Check here if this is a change of address.  
 Telephone: 602-809-2959  
 E-mail Address rfwaz66@yahoo.com

I (We) intend to hold the claims(s) and/or site(s) listed below for the calendar year 2013, and I (We) have filed or will file a Notice of Intent to Hold in the county where the claim (s) is located.

Reason for filing a Notice of Intent to Hold instead of an assessment work filing (check one):

- Maintenance fee was paid to maintain claim(s) during this assessment year.
- Mill or tunnel sites.
- Claim(s) was located during the current assessment year.
- BLM has deferred assessment work (attach copy of decision granting deferment, or pending petition for deferment including date petition was filed.)

Line No.	AMC NUMBER	CLAIM/SITE NAME	COUNTY RECORDER DATA (If available)	TWP	RNG	SEC
1	AMC417748	No Clue #1		4N	9W	7
2	417749	NO clue #2				
3						
4						
5						
6						
7						
8						
9						
10						

ENTERED  
 SEP 06 2013  
 BY: AT



NOTICE OF INTENTION TO HOLD MINING CLAIMS/SITES  
page 2

BLM Date Stamp	2013 AUG 21 A 11:45 PHOENIX, ARIZONA RECEIVED BLM STATE OFFICE
----------------------	---

1. State of Arizona, County of \_\_\_\_\_

2. I (Name) \_\_\_\_\_

3. Reside at (Address) \_\_\_\_\_

City \_\_\_\_\_ County \_\_\_\_\_ State \_\_\_\_\_ Zip \_\_\_\_\_ being duly sworn, depose and

say that I am a citizen of the United States, more than eighteen years of age, that all of the facts set forth in this notice, subject to the provisions and penalties of 18 U.S.C. 1001 pertaining to the filing of false, fictitious, or fraudulent statements with the United States, are true and correct according to the best of my knowledge, information and belief.

4. Owner's name and address (If not shown in Items 1-3 above). \_\_\_\_\_

5. Dated: \_\_\_\_\_ Signature: \_\_\_\_\_

Bureau of Land Management  
Arizona State Office  
[www.az.blm.gov](http://www.az.blm.gov)

No. of Claims:	2	x \$10 =	20
Check No:	CC	Init.	YMU
Receipt No.:	2861022		
For BLM Use Only			

**NOTICE OF INTENTION TO HOLD MINING CLAIMS/SITES**

When Recorded Return Document to:

\_\_\_\_\_  
\_\_\_\_\_  
\_\_\_\_\_

BLM  
Date  
Stamp

Check here if this is a change of address.

Telephone: \_\_\_\_\_

E-mail Address \_\_\_\_\_

I (We) intend to hold the claims(s) and/or site(s) listed below for the calendar year 20\_\_\_\_, and I (We) have filed or will file a Notice of Intent to Hold in the county where the claim (s) is located.

Reason for filing a Notice of Intent to Hold instead of an assessment work filing (check one):

- Maintenance fee was paid to maintain claim(s) during this assessment year.
- Mill or tunnel sites.
- Claim(s) was located during the current assessment year.
- BLM has deferred assessment work (attach copy of decision granting deferment, or pending petition for deferment including date petition was filed.)

Line No.	AMC NUMBER	CLAIM/SITE NAME	COUNTY RECORDER DATA (If available)	TWP	RNG	SEC
1						
2						
3						
4						
5						
6						
7						
8						
9						
10						

United States Department of the Interior  
 Bureau of Land Management  
 LANDS/RECREATION & PLANNING  
 ONE N CENTRAL AVE  
 PHOENIX, AZ 85004 -2203  
 Phone: 602-417-9200

Receipt

No: 2861022

<b>Transaction #:</b> 2946889	
<b>Date of Transaction:</b> 08/21/2013	
<b>CUSTOMER:</b>	
RUSSELL WILLIAMS 9064 E GARY LN MESA, AZ 85207-4236 US	

LINE #	QTY	DESCRIPTION	REMARKS	UNIT PRICE	TOTAL
1	1.00	LOCATABLE MINERALS / MINING CLAIMS-NOT NEW-UNADJUD, ONE AUTH NO. ONLY / MINING CLAIM MONEY RECEIVED CASES: AMC417748/\$20.00	NOI 2013/2 WAV	- n/a -	20.00
<b>TOTAL:</b>					<b>\$20.00</b>

PAYMENT INFORMATION			
NOTE: Items will appear on credit card statement as "Bureau of Land Mgmt CO".			
1	AMOUNT:	20.00	POSTMARKED: N/A
	TYPE:	CREDIT CARD	RECEIVED: 08/21/2013
	NAME:	WILLIAMS, RUSSELL 9064 E GARY LN MESA AZ 85207-4236 US	
	CARD NO:	XXXXXXXXXXXX9237	AUTH CODE: 08368G
	NAME ON CARD:	RUSSELL F WILLIAMS	
	EXPIRES:	08/2016	
	SIGNATURE:		

REMARKS

This receipt was generated by the automated BLM Collections and Billing System and is a paper representation of a portion of the official electronic record contained therein.

**NOTICE!!**

**These documents have been scanned!**

**Do not place un-scanned documents beneath this notice!**

**Do not remove this notice from this file!**

GPO Jacket No. 560-102  
Print Order 61540  
Rise Business Services, LLC  
Job=AZ15 5/13/2019



Box Number= AZ15044



Claim Begin-End: AMC417748-AMC417749

6 Location Notices-Amendments and Supporting Documents



AZ15044-7

AMC417667-AMC418586



**DEPARTMENT OF THE INTERIOR  
BUREAU OF LAND MANAGEMENT  
MINING CLAIMS**

**(LIVE) Serial Register Page**

Run Date/Time: 10/18/2012 04:28 PM

Page 1 of :

01 10-21-1976;090STAT0090;43USC1744  
 Case Type 384201: PLACER CLAIM  
 Claim Name: NO CLUE #1  
 Commodity :  
 Case Disposition: ACTIVE  
 Required Maintenance Fee: \$140.00

Total Acres  
 20.000

Serial Number  
 AMC417748  
 Lead File Number  
 AMC417748

Name & Address	Int Rel	% Interest
WILLIAMS RUSSELL✓ 9064 E GARY LN MESA, AZ 85207-4236	CLAIMANT	0.0000000

Mer Twp	Rng	Sec	Quadrant	District/Field Office	County
14	0040N	0090W	007 NE	HASSAYAMPA FO	MARICOPA

Act Date	Code	Action	Action Remarks	Receipt Number
09/01/2012	403	LOCATION DATE		
10/09/2012	395	RECORDATION NOTICE RECD	1	2668338
10/09/2012	484	LOCATION YEAR / MAINTENANCE	2013;\$140	2668338
10/09/2012	501	ACCT ADV IN LEAD FILE	AMC417748-AMC417749;	

Line Nr Remarks

AMC417748, AMC417749

**DEPARTMENT OF THE INTERIOR  
BUREAU OF LAND MANAGEMENT  
MINING CLAIMS  
(LIVE) Serial Register Page**

RunDate/Time: 10/18/12 04:28 PM

Page 1 of 1

**Total Rows Returned: 2**

**Limit Criteria:**

---

Serial Number: AMC417748, AMC417749

**NO WARRANTY IS MADE BY BLM  
FOR USE OF THE DATA FOR  
PURPOSES NOT INTENDED BY BLM**

**DEPARTMENT OF THE INTERIOR  
BUREAU OF LAND MANAGEMENT  
MINING CLAIMS**

**(LIVE) Serial Register Page**

Run Date/Time: 10/18/2012 04:28 PM

Page 2 of :

01 10-21-1976;090STAT0090;43USC1744

**Total Acres**  
20.000

**Serial Number**  
AMC417749  
**Lead File Number**  
AMC417748

Case Type 384201: PLACER CLAIM

Claim Name: NO CLUE #2

Commodity :

Case Disposition: ACTIVE

Required Maintenance Fee: \$140.00

Name & Address	Int Rel	% Interest
WILLIAMS SCOTT ✓ 9064 E GARY LN MESA, AZ 85207-4236	CLAIMANT	0.0000000

Mer Twp	Rng	Sec	Quadrant	District/Field Office	County
14	0040N	0090W	008 NW	HASSAYAMPA FO	MARICOPA

Act Date	Code	Action	Action Remarks	Receipt Number
09/01/2012	403	LOCATION DATE		
10/09/2012	395	RECORDATION NOTICE RECD	1	2668338
10/09/2012	484	LOCATION YEAR / MAINTENANCE	2013;\$140	2668338
10/09/2012	501	ACCT ADV IN LEAD FILE	AMC417748-AMC417749;	

Line Nr Remarks

# MINING CLAIM STATUS REPORT

*Jme*  
*Jme*

DATA ENTERED OCT 18 2012 *pb*

MTP Checked by \_\_\_\_\_  
GEO Checked by \_\_\_\_\_

LEAD SERIAL NUMBER AMC 417748 thru AMC 417749

# OF CLAIMS & TYPE	CHARGES
# <u>2</u> LODE	Location Fee @ \$34 = \$ <u>68</u>
# <u>2</u> PLACER	Processing Fee @ \$15 = \$ <u>30</u>
# _____ ASSOCIATION PLACER	Maintenance Fee @ \$140 = \$ <u>280</u>
# _____ MILL SITE	Overage (+) \$ _____
# _____ TUNNEL SITE	Shortage (-) \$ _____
	Other Fees \$ _____
	<b>TOTAL \$ <u>378</u></b>

TOTAL CLAIM ACREAGE? 20 acres

# OF LOCATORS? \_\_\_\_\_

DOCUMENTS RECEIVED VIA - TIMELY FILED?  
 Over-the-Counter () Mail () Yes () No ()

LEGAL DESCRIPTION - T 4W R 9W SEC 7, 8  
 T \_\_\_\_\_ R \_\_\_\_\_ SEC \_\_\_\_\_  
 T \_\_\_\_\_ R \_\_\_\_\_ SEC \_\_\_\_\_  
 T \_\_\_\_\_ R \_\_\_\_\_ SEC \_\_\_\_\_

BLM () FOREST SERVICE () \_\_\_\_\_ SUBJ TO PL 359: Yes () No ()

WILDERNESS AREA: No () Yes () \_\_\_\_\_

SPLIT ESTATE - N/A () SX () PX () SRHA () OTHER () \_\_\_\_\_  
 Proper Notice Filed if Located on SHRA Lands? N/A () Yes () No ()

RECONVEYED MINERALS ON BLM LANDS REQUIRE OPENING ORDERS FROM 1944 TO 1993 -  
 Open to Entry on: \_\_\_\_\_ N/A ()

COMMENTS/STATUS - VOID () PARTIALLY VOID () PVT MINERALS () WITHDRAWN LANDS ()  
 OTHER () \_\_\_\_\_

Claimant acknowledges that portions of the following claims(s) site(s) may be void or voidable.

Printed Name of Claimant \_\_\_\_\_ Signature of Claimant \_\_\_\_\_

\*\*\*\*\* FINAL ADJUDICATION \*\*\*\*\*

DATE MAY 06 2013 INITIALS pb

ANCH 417748



LOCATION NOTICE FOR PLACER MINING CLAIM

NOTICE IS HEREBY GIVEN that the NO CLUE #1

placer mining claim has been located by

Russell WILLIAMS whose current mailing

address is 9064 E. GARY LN.  
MESA, AZ. 85207

RECEIVED  
BLM AZ STATE OFFICE  
2012 OCT -9 P 12:02  
PHOENIX, ARIZONA  
BLM  
Date  
Stamp

OCT 18 2012

Entered New ID  
PB

The general course of this claim is North to South and it is situated in

Maricopa County, Arizona.

This claim is 1320 feet in length and 660 feet in width. This claim runs from the

location monument on which this location notice is posted approximately 221 feet in a Southerly direction to the South end line and 1099 feet in a Northerly direction to the North end line.

This claim is marked by four monuments, one at each corner of the claim.

The location monument on which this notice is posted is situated within Section 7, Township

4 N, Range 9 W, Gila Salt River Base and Meridian, Arizona. This claim encompasses

portions of the following legal subdivision(s) if located by legal subdivision or the following quarter section (s),

section (s), Township (s) and Range (s) NE1/4, Sec. 7, T4N, R9W

Gila Salt River Base and Meridian, Arizona.

The locality of this claim with reference to some natural object or permanent monument and additional

information (if any) concerning its locality are as follows: The NE corner of this claim lies 233' S.180

degrees of the NE corner Sec .7 USGS monument marker

DATED AND POSTED on the ground this 1st day of September, 20 12

LOCATOR (s) Russell Williams

Form MCF102  
Revised July 2005

This form is available from the Arizona Department of Mines & Mineral Resources and may be reproduced.

AN0417748

**MINING CLAIM MAP**

Lode ( ) Placer (X)

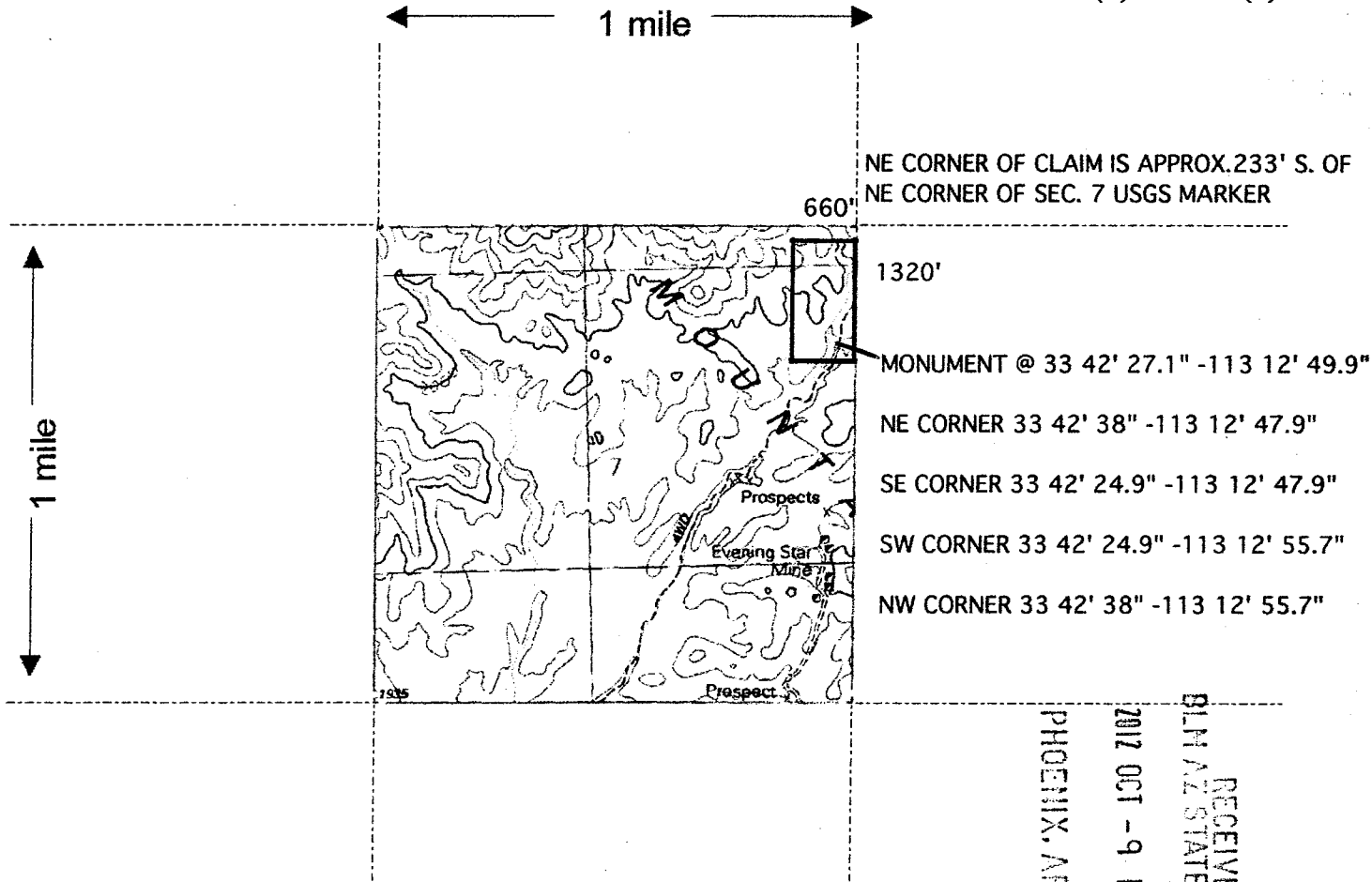

Scale : 1" = 2000 feet



RECEIVED  
 BLM AZ STATE OFFICE  
 2012 OCT - 9 P 12: 02  
 PHOENIX, ARIZONA

ANCM 17749

1. The above map depicts the NO CLUE #1 mining claim, which is located in Section (s) 7, Township 4 N, Range 9 W, Gila and Salt River Base and Meridian, MARICOPA County, Arizona.

2. The type of corner and location monuments used are as follows: PLASTIC PIPE

3. The bearings and distances in degrees and feet between claim corners are as depicted on the map.

Form MCF100a  
 Revised July 2005



MONUMENT 33 42' 32.5" -113 12' 46.1

### MINING CLAIM MAP

Lode ( ) Placer (x)

NW CORNER 33 42'38" -113 12' 47.9"

1 mile

SW CORNER 33 42' 24.9" -113 12' 47.9"

SE CORNER 33 42' 24.9" -113 12' 40.1"

NW CORNER OF CLAIM IS APPROX. 233' S. OF NW CORNER SEC. 8 USGS MARKER

~~SW~~ <sup>NE</sup> CORNER 33 42' 38" -113 12' 40.1"

660'

1320'  
MONUMENT

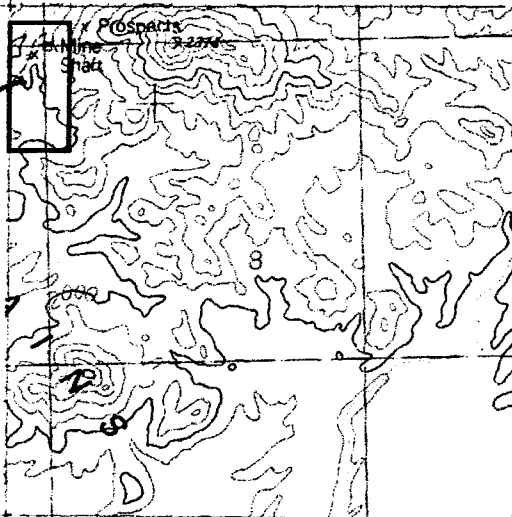

1 mile

RECEIVED  
BLM AZ STATE OFFICE  
2012 OCT -9 P 12:02  
PHOENIX, ARIZONA

Scale : 1" = 2000 feet



1. The above map depicts the NO CLUE #2 mining claim, which is located in Section (s) 8, Township 4 N, Range 9 W, Gila and Salt River Base and Meridian, MARICOPA County, Arizona.

2. The type of corner and location monuments used are as follows: PLASTIC PIPE

3. The bearings and distances in degrees and feet between claim corners are as depicted on the map.

Form MCF100a  
Revised July 2005

This form is available from the Arizona Department of Mines & Mineral Resources and may be reproduced.

ANCM 17749



RUN TIME: 01:04 PM

DEPARTMENT OF INTERIOR  
BUREAU OF LAND MANAGEMENT

RUN DATE: 10/09/2012

Input Parameters for Geographic Report with Land

System Id = CR

Admin State = AZ

Geo State =

Casetype =

Casetype Txt =

Case Disp Txt = AUTHORIZED, CANCELLED, EXPIRED, PENDING, REJECTED, RELINQUISHED, VOID, WITHDRAWN

Mer Twp Rng =

Mtrs = 14 0040N 0090W 007, 14 0040N 0090W 008, 14 0040N 0090W 999

Commodity =

Commodity Txt =

Adm Agency Begins With

Total Rows Returned: 0

NO WARRANTY IS MADE BY BLM FOR USE OF THE DATA  
FOR PURPOSES NOT INTENDED BY BLM

